

# PACAH

Pennsylvania Coalition of Affiliated  
Healthcare & Living Communities

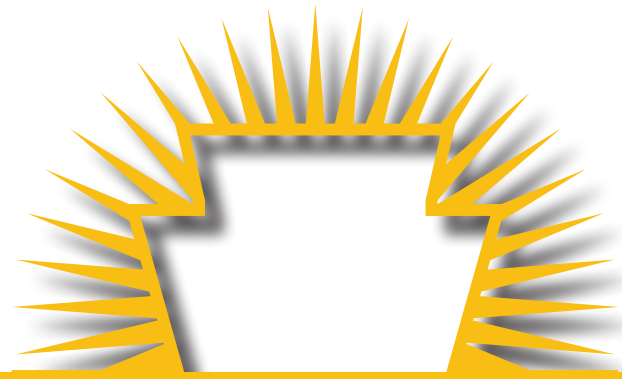

# 2018

**April 24 - 27, 2018**

Penn Stater Hotel and Conference Center  
State College, Pennsylvania

# SPRING CONFERENCE

# FULL SERVICE MANAGEMENT AND CONSULTING

*For Nursing Homes, Senior Living and Continuing Care Retirement Communities*



## IS YOUR NURSING FACILITY PREPARED...

*for* COMMUNITY HEALTH CHOICES MEDICAID  
MANAGED CARE?

*for* PHASE III OF THE NEW FEDERAL REGULATIONS?

*for* THE NEW MEDICARE PAYMENT SYSTEM?

---

*We work with your staff to develop the **systems,**  
**processes** and **education** needed to be successful  
in this quickly changing long term care environment!*

---



**Complete HealthCare Resources** EASTERN, INC.

STRATEGIC SOLUTIONS FOR SENIOR CARE PROVIDERS

**800-951-0410**

[completehealthcareresources.com](http://completehealthcareresources.com)





## TABLE OF CONTENTS

|  |         |
|--|---------|
| President's & Executive Director's Welcome ..... | 4 - 5   |
| PACAH 2017-18 Executive Board Members .....      | 6       |
| Program Advertiser Listing .....                 | 7       |
| Sponsors.....                                    | 10 - 12 |
| Vendors .....                                    | 14 - 15 |
| Hotel & Local Information.....                   | 16 - 19 |
| Agenda at a Glance .....                         | 28 - 29 |
| Conference Agenda .....                          | 30 - 43 |
| Speakers.....                                    | 44 - 45 |

### WIRELESS INTERNET ACCESS

The Penn Stater Hotel and Conference Center offers complimentary high-speed wireless internet access throughout the entire property. No log-in is required.

1. Connect using "attwifi"
2. Once connected, you may need to open your internet browser to complete the connection

### NAME BADGES

All attendees and vendors must wear their PACAH conference badge to attend conference events.

### CEU TRACKING

PACAH now utilizes electronic badge scanning for all educational credit tracking. In order to receive continuing education hours for attended sessions, you must scan in prior to the start of each educational session as well as scan out after each session ends. Paper certificates will no longer be distributed to track educational credits.

### CONFERENCE COURTESY

As a courtesy to all attendees, we appreciate your cooperation by putting all cell phones and other electronic devices on "silent mode." This has become a necessary request given our current culture, but we hope everyone realizes its importance. Thank you for your cooperation and understanding.

### SMOKING POLICY

The Penn Stater Hotel and Conference Center provides guests with a non-smoking environment for their accommodations. Guests are reminded at the time of booking, during registration, and displayed signage in all rooms that smoking is not permitted in their hotel accommodations, but designated smoking areas are offered.





**Get all the benefits of a  
statewide association,  
at a price you can  
actually afford.**

**PACAH**  
Pennsylvania Coalition of Affiliated  
Healthcare & Living Communities

## **Make your voice heard - JOIN TODAY!**

### **PACAH MEMBERSHIP BENEFITS:**

- Affiliation with the County Commissioners Association of Pennsylvania (CCAP), giving members an instant lobbying influence unparalleled by other associations
- An association seat on CCAP's Human Services Committee and commissioner liaisons to PACAH, providing policy support from local elected officials
- One "FREE Call" with expert legal counsel plus follow-up reduced legal services
- Opportunity to sit on PACAH's committees
- Regular email and newsletter updates on issues impacting long-term care for an unlimited number of staff
- Access to PACAH Listserv to discuss issues with fellow members
- FREE webinars with CEUs
- Regional meetings to discuss issues with members
- Discounted registration fees to PACAH's two yearly statewide conferences, offering NHA, PC, RC/AL, Fiscal, Nursing and Dietary credits and the opportunity to network and learn from premier experts in the healthcare and long-term care industry
- FREE quarterly fiscal staff meetings with OLTL staff
- And more!

### **CONTACT**

Kelly Andrisano  
Executive Director  
[kandrisano@pacounties.org](mailto:kandrisano@pacounties.org)  
(717) 736-4740

Kim Deline  
Meeting & Marketing Manager  
[kdeline@pacounties.org](mailto:kdeline@pacounties.org)  
(717) 736-4741



**WWW.PACAHPA.ORG**



# Welcome from PACAH's Executive Director

Dear PACAH members and conference attendees –

**W**elcome to PACAH's 2018 Spring Conference! We at PACAH continue to strive to bring you the best educational opportunities, provide comprehensive statewide advocacy, and keep you up-to-date on issues impacting your ability to provide services in the long-term care arena. Your choice to participate in our Spring Conference shows your commitment long-term care.

With the unprecedented changes to long-term care that we are currently seeing, I believe it is more important than ever for nursing facility administrators, staff, and providers to remain up-to date and educated. The implementation of Community HealthChoices (CHC) in the Southwest region of Pennsylvania has been one of these unprecedented changes. PACAH has been extraordinarily busy assisting members and helping to educate and inform the managed care organizations (MCOs) and state administrative staff on how best to implement the changes and their impact on facilities and residents. Unique issues continue to be addressed daily, and PACAH has an integral role in assisting in the distribution of the Access to Care Payments. We think that due to the hard work of PACAH, as well as our Southwest facilities, we have minimized issues in the first few months, but continue to encourage all members to reach out to us.

In addition to this, over the past few months we have worked closely with our President, William D'Amico and key members to increase advocacy on other important issues facing our nursing facilities. We have met with legislative leaders, as well as the new Secretary of the Department of Human Services, Teresa Miller, to discuss these issues. We are also actively participating in the workgroup that is charged with facilitating the revision of Pa.'s Long-term Care Regulations. We are happy to report that as a result of some of the advocacy we were able to come to an agreement on how to distribute additional Intergovernmental Transfer (Safety Net) funds to our county facilities. We know this is critical for our county nursing facilities who are in desperate need of additional funding.

Despite everything that is going on, I remain confident in our membership's ability to adapt and succeed. You have met the challenges that have been thrown at you and continued to not only do your jobs, but find ways to make improvements. Whether you are focusing on the quality of care, finding new ways to deliver services, or coming up with strategies to improve your bottom line, I never fail to be amazed at what our members accomplish each day.

At PACAH, we will continue to support you through all of this. We will continue our regular communication with DHS, DOH, elected officials, and MCOs. We will also continue to negotiate payment mechanisms and policy positions that best support all of you. We continue to have top-notch education on a regular basis, and neither Kim Deline nor I are ever more than a phone call or email away.

Hopefully, at this conference members will be able to learn as much as possible while also taking the time to network and relax. We are very excited for our wide variety of conference social events and hope all attendees – members, non-members, vendors, and business partners are able to take advantage of everything PACAH has to offer. If you are not a PACAH member, I hope you take a minute to talk to our Meeting and Marketing Manager Kim Deline or myself to find out a little more about PACAH.

Along with our President, William D'Amico, Executive Board, and Kim, I want to thank all sponsors, vendors, and attendees for making this conference a success!

Have a wonderful conference!

Kelly Andrisano  
Executive Director  
PACAH



# PACAH 2017-18 EXECUTIVE BOARD MEMBERS

## **PRESIDENT**

William D'Amico  
Fair Acres Geriatric Center

## **PRESIDENT ELECT**

Jennifer Eslinger  
Conestoga View Nursing & Rehabilitation

## **1ST VICE PRESIDENT**

Frank Geramita  
LaFayette Manor, Inc.

## **2ND VICE PRESIDENT**

Barbara Raymond  
Pennsylvania Soldiers' and Sailors' Home

## **SECRETARY**

LouAnn Simpson  
Valley View Nursing Center

## **TREASURER**

Kimberly Cobough  
Communities at Indian Haven

## **IMMEDIATE PAST PRESIDENT**

Terence Brennan  
Berks Heim Nursing and Rehabilitation

## **BOARD MEMBER**

Alvin W. Allison  
Baptist Homes Society and  
Providence Point

## **BOARD MEMBER**

Molly Hess  
Philadelphia Nursing Home/Fairmount  
Long Term Care

## **BOARD MEMBER**

Nancy Pastorius  
UPMC Northwest TCU/Sugar Creek Station

## **BOARD MEMBER**

Rebecca Shoop  
Belair Health & Rehabilitation Center

Expertise, Commitment

# RESULTS

## PREMIER

### THERAPY

embrace the  
difference



Contract Rehabilitation Provider of:

- ▶ Physical Therapy
- ▶ Occupational Therapy
- ▶ Speech Therapy

## Value Added Services

- ▶ CMI Initiative Specialist
- ▶ Compliance Analyst Audit
- ▶ Customized Clinical Reports
- ▶ Monthly Financial Reports
- ▶ Triple Check Billing Audit
- ▶ Signature Programs

*Vicki Esoldo Javens, President/Owner*

**800.875.7041**

EmbracePremier.com





# A SPECIAL THANKS TO OUR PROGRAM ADVERTISERS!

|  |    |
|--|----|
| 360Care.....   | 9  |
| Absolute Rehabilitation .....                        | 7  |
| Advantage Continuum of Care .....                    | 9  |
| Affinity Health Services, Inc.....                   | 22 |
| Allstar Therapies, Inc. ....                         | 26 |
| Apex Rehab Solutions. ....                           | 13 |
| Arnett Carbis Toothman, LLP .....                    | 26 |
| Calmoseptine, Inc. ....                              | 21 |
| Complete HealthCare Resources -<br>Eastern, Inc..... | 2  |
| Elwyn Specialty Care .....                           | 20 |
| Express Mobile Diagnostics Services, LLC ....        | 23 |
| Functional Pathways .....                            | 22 |
| Garda Rx, LLC .....                                  | 13 |
| Guardian Elder Care .....                            | 25 |
| Harris Medical, LLC.....                             | 12 |
| Kennedy, PC Law Offices .....                        | 21 |
| Klenzoid, Inc. ....                                  | 8  |
| Latsha Davis & McKenna, PC.....                      | 23 |
| PELICAN Insurance, RRG .....                         | 47 |
| Phoebe Services Pharmacy .....                       | 7  |
| Physician's Mobile X-Ray.....                        | 21 |
| Premier Therapy .....                                | 6  |
| Stantec Architecture .....                           | 8  |
| UPMC Community HealthChoices .....                   | 24 |



## ALWAYS RESPECT.

Respect is integrated into everything we do.

Absolute Rehabilitation is the preferred provider of comprehensive physical, occupational and speech therapy in long-term care settings.

We show consideration for people and processes as we partner with clients to properly manage care and deliver quality rehab services.

**Let us earn your respect.**

✉ John Vesely at [jvesely@abstherapy.com](mailto:jvesely@abstherapy.com)  
☎ 333.704.5383

339 East Maple Street | Suite 100  
North Canton, OH 44720  
[www.abshealth.com](http://www.abshealth.com)



## PHOEBE PHARMACY

**WE'RE HERE TO HELP.**

Allentown  
610-794-5380

Lancaster  
717-925-2380

[PHOEBEPHARMACY.ORG](http://PHOEBEPHARMACY.ORG)

**Klenzoid**  
*inc*  
*Water Treatment*  
**800-825-9495**

# YOUR COMPLETE SOLUTION FOR WATER HYGIENE

- Water Management Plans
- Education/Training
- Legionella Testing
- Secondary Disinfection
- Patented Technologies
- Remote Monitoring



Inspiring innovation:  
Responsive **design**  
for senior living



Design with community in mind  
[stantec.com/senior-care](http://stantec.com/senior-care)

Pittsburgh • State College • Philadelphia





# Advantage Continuum of Care

From offering our home health monitoring service to the residents of a client's assisted living facility, to leveraging best practices from our contract therapy operations for our consulting services, to enabling therapists to stay with a patient as the patient moves from a care facility to home treatment - the Advantage companies work together to deliver innovative and effective solutions that ultimately improve outcomes.



Better outcomes come with a better team...  
***The Advantage Team!***

(844) 275-2205 | [www.feeltheadvantage.com](http://www.feeltheadvantage.com)



WE TAKE  
**ANCILLARY CARE**  
TO THE **NEXT LEVEL**

Invite us in...and feel the difference



#### DENTAL

- X-rays and simple extractions
- Dentures customized for a perfect fit labeled with Resident's name



#### VISION

- Glasses labeled with Resident's name and date
- State of the art equipment for retinal photos and accurate prescription measurement for Residents with cognitive communication deficits



#### EMR

- EMR and same day consult notes
- Patient portals available for Facility, Resident, and approved family members



#### PODIATRY

- Comprehensive podiatry care for your Resident with medical necessity on a regular basis ensuring compliance



#### AUDIOLOGY

- Digital Hearing Aids
- On-site diagnostic assessment

FALL RISK ASSESSMENTS  
AND INTERVENTIONS



[WWW.360CARE.COM](http://WWW.360CARE.COM) | 855-259-9183

# PACAH'S 2018 SPRING SPONSORS

## **Complete HealthCare Resources-Eastern, Inc.**

*ELITE SPONSOR - Welcome Party*

[completehealthcareresources.com](http://completehealthcareresources.com)  
Ed Balliet, Chief Operating Officer  
(570) 690-6844  
[eballiet@chrmail.com](mailto:eballiet@chrmail.com)



**Complete HealthCare Resources** EASTERN, INC.  
STRATEGIC SOLUTIONS FOR SENIOR CARE PROVIDERS

Complete HealthCare Resources-Eastern, Inc. serves a wide range of not-for-profit, county and for-profit elder care communities. They are the region's "go to" experts on timely trends and developments in this rapidly changing industry. Clients include long-term and personal care facilities as well as assisted living homes and residential retirement communities. Over the years, Complete HealthCare Resources-Eastern Inc. has become a leader in bringing optimal profitability, productivity, compliance and, most of all, improving the residents' lives in the communities we serve.

## **UPMC Community HealthChoices**

*EXCLUSIVE SPONSOR - Golf Outing*

[upmchealthplan.com/chc](http://upmchealthplan.com/chc)  
Ray Prushnok, Associate Vice President, Community HealthChoices  
(412) 454-8305  
[burnscj@upmc.edu](mailto:burnscj@upmc.edu)

**UPMC Community  
HealthChoices**

UPMC Health Plan, headquartered in Pittsburgh, Pa., is among the nation's fastest-growing health plans. It is owned by UPMC, a world-renowned health care provider. As part of an integrated health care delivery system, UPMC Health Plan is committed to providing its members better health, more financial security, and the peace of mind they deserve. UPMC Community HealthChoices offers a wide variety of medical and long-term services and supports to help our members stay as healthy and independent as possible.

## **PELICAN Insurance, RRG**

*PREMIER SPONSOR - Keynote Speaker*

[pacounties.org/Insurance/PELICAN/Pages/default.aspx](http://pacounties.org/Insurance/PELICAN/Pages/default.aspx)  
Andrew Smith, Risk Control Specialist/PELICAN Marketing Specialist  
(717) 736-4769  
[asmith@pacounties.org](mailto:asmith@pacounties.org)



PELICAN Insurance is a Risk Retentions Group (RRG) based out of Vermont and is a sponsored program of PACAH. PELICAN provides General Liability and Professional Liability insurance coverage to all nursing homes in Pennsylvania and Maryland. PELICAN offers dedicated and personal Risk Control and Claims Representatives who are focused on providing excellent customer services to PELICAN members. PELICAN is a non-profit group so they regularly return surplus to their members as dividends.

## **Guardian Elder Care**

*PREMIER SPONSOR - Vendor Show*

[guardianeldercare.com](http://guardianeldercare.com)  
Christopher B. Bailey, Executive Director of Management Services  
(814) 483-9966  
[christopher.bailey@guardianeldercare.net](mailto:christopher.bailey@guardianeldercare.net)



Guardian Elder Care is a privately owned healthcare organization providing services to communities in Pennsylvania, Ohio, and West Virginia. Guardian also operates ancillary divisions to provide pharmacy, rehabilitation, advanced practitioner services, home health and home care services. Guardian Elder Care is now offering management services for nursing care facilities, CCRC's and senior living communities. Their experienced team offers operations, clinical, financial, and business development "CORE" services, plus many other flexible solutions customized for your facility including business office services, nurse practitioner services, and staffing.



# PACAH'S 2018 SPRING SPONSORS

## AdvantageCare Rehabilitation, Inc.

feeltheadvantage.com  
Chaz Balsano  
Business Development  
(412) 508-4899  
chazbalsano@feeltheadvantage.com



**ONLINE REGISTRATION**

## Allstar Therapies, Inc.

allstartherapies.com  
Tim Kubistek  
Vice President of Operations  
(724) 327-3553  
tkubistek@allstartherapies.com



**OVERNIGHT GUEST WELCOME BAGS**

## Elwyn Specialty Care

elwynspecialtycare.com  
Regina McGowan  
Director of Business Development  
(610) 545-6040  
RMcGowan@elwynspecialtycare.com



**CONTINUING EDUCATION TRACKING**

## Functional Pathways

functionalpathways.com  
Robert Mitchell  
Regional VP of Strategic Development  
(888) 531-2204  
rmitchell@fprehab.com



**WINE OUTING**

## Premier Therapy, LLC

embracepremier.com  
Scott Slipko  
Business Development Manager  
(724) 417-8840  
sslipko@embracepremier.com



**HOTEL ROOM KEY CARDS**

## GOLD SPONSORS



## Affinity Health Services

affinityhealthservices.net  
Kimberly Kelly-Clutter  
Director of Marketing & Business Development  
(724) 463-1010  
kkc@affinityhealthservices.net



**WINE OUTING**

## Apex Rehab Solutions

apexrehabolutions.com  
Tracy Maxwell, MA, SLP  
President  
(412) 963-3698  
maxwell@apexrehabolutions.com



**CONFERENCE PARTY**

## Express Mobile Diagnostic Services, LLC

expressmobilediagnostic.com  
Jamie Bostard  
Chief Executive Officer  
(724) 327-3557  
jbstard@exmds.com



**NEW MEMBER & ATTENDEE HAPPY HOUR**

## Kennedy, PC Law Offices

kennedypc.net  
John N. Kennedy, Esq.  
President & CEO  
(717) 233-7100  
jkennedy@kennedypc.net



**CONFERENCE REGISTRATION**

**Sponsorships listed are up-to-date  
as of April 2, 2018**

# PACAH'S 2018 SPRING SPONSORS

## SILVER SPONSORS

### Harris Medical, LLC

*wc19transitwheelchair.com*  
Robert "Bud" Harris, Owner  
(954) 609-4214

*Bud.harris@eztransportchair.com*  
**4/25 CONTINENTAL BREAKFAST**

### GardaRx, LLC

*gardarx.com*  
Diane Martinez, VP Business Development  
(724) 568-4144

*diane.martinez@gardarx.com*  
**4/26 CONTINENTAL BREAKFAST**

## BRONZE SPONSORS

### Absolute Rehabilitation

*abshealth.com*  
John Vesely, Director of Business Development  
(330) 704-5383

*jvesely@abstherapy.com*  
**4/26 MORNING BREAK**

### 360care

*360care.com*  
Mark Rostick, VP East Region  
(484) 43-4884

*Mrostick@360care.com*  
**4/26 AFTERNOON BREAK**

## PARTNER SPONSORS

### Stantec Architecture

*stantec.com/en*  
Thomas Grden, Principal  
(412) 394-7101  
*thomas.grden@stantec.com*

**GOLF OUTING PRIZE**

### Calmoseptine, Inc.

*calmoseptineointment.com*  
(800) 800-3405  
*info@calmoseptineointment.com*

**TOTE BAG INSERT**

### Physician's Mobile X-Ray

*pmx-ray.com*  
Rian Bender, Director of Sales/Marketing  
(717) 561-4940  
*rbender@pmx-ray.com*

**TOTE BAG INSERT**

*Harris Medical, LLC presents*

## The EZ Transport Chair

\*New for 2018 we are offering two models

**Standard 300lb and Bariatric 500lb**

Offers 21 degrees of Trendelenberg,  
residents can be dialyzed in the chair.

Average Annual savings are \$70,000

Use your transport vehicle and the EZ  
Transport Chair and virtually eliminate the need  
for a costly ambulance for BLS transports.

No moving patient as they can stay in the  
chair for dialysis

### **Harris Medical, LLC**

8909 SE Marina Bay dr.  
Hobe Sound, FL 33455



### **Bud Harris**

President  
954-609-4214  
*budharris@eztransportchair.com*

### **Brian Harris**

Sales Director  
484-358-7940  
*brbharris.eztransport@gmail.com*



Change Can Make a Difference!

Find out how.



**Apex**  
REHAB SOLUTIONS

412-963-9698 x10260  
apexrehabolutions.com

**Garda Rx**



*Customized Service • 24/7 Availability • Clinical Consulting*

Garda Rx is an independently owned and operated long-term care pharmacy located in Western Pennsylvania. We provide unparalleled customer service that advocates a higher standard of resident care and exceeds our clients' expectations.

Contact us today to learn how Garda Rx can draw on our proven experience and technology driven solutions to serve your facility.

724-568-4144 | [www.gardarx.com](http://www.gardarx.com)



# PACAH

Pennsylvania Coalition of Affiliated  
Healthcare & Living Communities

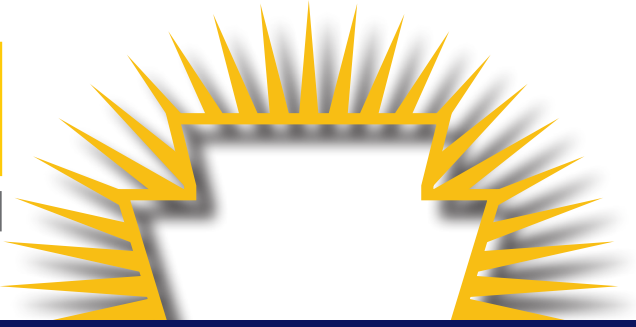

## 2018 SPRING VENDOR SHOW

Thursday, April 26 from 3:45 - 6 p.m.

### **360care**

Mark Rostic, VP Sales, East Region  
[mrostick@360care.com](mailto:mrostick@360care.com)  
[360care.com](http://360care.com)

### **Absolute Rehabilitation**

John Vesely, Director of Business  
Development  
[jvesely@abstherapy.com](mailto:jvesely@abstherapy.com)  
[abshealth.com](http://abshealth.com)

### **AdvantageCare Rehabilitation, Inc.**

Austin Hancock, Regional Director of  
Business Development  
[eahancock@feeltheadvantage.com](mailto:eahancock@feeltheadvantage.com)  
[feeltheadvantage.com](http://feeltheadvantage.com)

### **Affinity Health Services**

Kimberly Kelly-Clutter, Director of  
Marketing and Business Development  
[kkc@affinityhealthservices.net](mailto:kkc@affinityhealthservices.net)  
[affinityhealthservices.net](http://affinityhealthservices.net)

### **Allstar Therapies, LLC**

Tim Kubistek, Vice President of  
Operations  
[tkubistek@allstartherapies.com](mailto:tkubistek@allstartherapies.com)  
[allstartherapies.com](http://allstartherapies.com)

### **AmeriHealth Caritas Pennsylvania**

Jill Blessington, Manager Provider,  
Network Management  
[jblessington@amerihealthcaritaspa.com](mailto:jblessington@amerihealthcaritaspa.com)  
[amerihealthcaritaspa.com](http://amerihealthcaritaspa.com)

### **Apex Rehab Solutions**

Scott Sosso, Director of Business  
Development  
[ssosso@pas-lp.com](mailto:ssosso@pas-lp.com)

Tracy Maxwell, President  
[tmaxwell@apexrehabolutions.com](mailto:tmaxwell@apexrehabolutions.com)  
[apexrehabolutions.com](http://apexrehabolutions.com)

### **Biocodex USA**

Sarah Kennedy, Sales Consultant  
[s.kennedy@biocodex.com](mailto:s.kennedy@biocodex.com)  
[biocodex.us/en](http://biocodex.us/en)

### **BlueOrange Compliance**

Michael Freedman, Client Consultant  
[michael.freedman@blueorangecompliance.com](mailto:michael.freedman@blueorangecompliance.com)  
[blueorangecompliance.com](http://blueorangecompliance.com)

### **Bollinger Energy**

Gary Murphy, Business Development  
Director  
[gary@bollingerenergy.com](mailto:gary@bollingerenergy.com)  
[bollingerenergy.com](http://bollingerenergy.com)

### **Chestnut Ridge Foam, Inc.**

Steve Rymarowicz, Healthcare Sales  
Manager  
[srymarowicz@crfoam.com](mailto:srymarowicz@crfoam.com)  
[chestnutridgefoam.com](http://chestnutridgefoam.com)

### **Columbia Ancillary Services**

Robin Nagy, Director of Business  
Development & Customer Service  
[Rnagy@cas.jdkmgt.com](mailto:Rnagy@cas.jdkmgt.com)  
[columbiaancillaryservices.com](http://columbiaancillaryservices.com)

### **Complete HealthCare Resources – Eastern, Inc.**

Ed Balliet, Chief Operating Officer  
[eballiet@chrmail.com](mailto:eballiet@chrmail.com)  
[completehealthcareresources.com](http://completehealthcareresources.com)

### **County Commissioners Association of Pennsylvania (CCAP)**

Lisa Schaefer, Director of  
Government Relations  
[lschaefer@pacounties.org](mailto:lschaefer@pacounties.org)  
[pacounties.org](http://pacounties.org)

### **Diamond Pharmacy Services**

Mike Rogalski, Medical Supply Sales  
Account Executive  
[mrogalski@diamondpharmacy.com](mailto:mrogalski@diamondpharmacy.com)  
[diamondpharmacy.com](http://diamondpharmacy.com)

### **Elwyn Specialty Care**

Regina McGowan, Director of Business  
Development  
[RMcGowan@elwynspecialtycare.com](mailto:RMcGowan@elwynspecialtycare.com)  
[elwynspecialtycare.com](http://elwynspecialtycare.com)

### **EMS, LLC**

Robert Dibble, Director of Business  
Development  
[rdibble@emsmgt.net](mailto:rdibble@emsmgt.net)  
[emsmgt.net](http://emsmgt.net)

### **Express Mobile Diagnostic Services, LLC**

Renee Negri, Director of Business  
Development & Client Service  
[rneгри@exmds.com](mailto:rneгри@exmds.com)  
[expressmobilediagnostic.com](http://expressmobilediagnostic.com)

### **Functional Pathways**

Robert Mitchell, Regional VP of  
Strategic Development  
[rmitchell@fprehab.com](mailto:rmitchell@fprehab.com)  
[fprehab.com](http://fprehab.com)

### **GardaRx**

Diane Martinez, VP Business  
Development  
[diane.martinez@gardarx.com](mailto:diane.martinez@gardarx.com)  
[gardarx.com](http://gardarx.com)

### **Guardian Elder Care**

Christopher Bailey, Executive Director  
of Management Services  
[christopher.bailey@guardianeldercare.net](mailto:christopher.bailey@guardianeldercare.net)  
[guardianeldercare.com](http://guardianeldercare.com)

**Harris Medical, LLC**

Robert "Bud" Harris, Owner  
[bud.harris@eztransportchair.com](mailto:bud.harris@eztransportchair.com)  
[eztransportchair.com](http://eztransportchair.com)

**HartmannUSA**

Brian Cully, Territory Manager  
[brian.cully@hartmann.info](mailto:brian.cully@hartmann.info)  
[us.hartmann.info](http://us.hartmann.info)

**IPPC Pharmacy**

Scott Burlew, Account Manager  
[burlew@ippcrx.com](mailto:burlew@ippcrx.com)  
[ippcrx.com](http://ippcrx.com)

**KCBA Architects**

Walt Zapor, Senior Associate  
[walter.zapor@kcba-architects.com](mailto:walter.zapor@kcba-architects.com)  
[kcba-architects.com](http://kcba-architects.com)

**Kennedy, PC Law Offices**

Kim Kennedy, Marketing Coordinator  
[kimkennedy@kennedypc.net](mailto:kimkennedy@kennedypc.net)  
[kennedypc.net](http://kennedypc.net)

**Klenzoid, Inc.**

Jeff Rudolph, President  
[Jeff\\_Rudolph@klenzoidinc.com](mailto:Jeff_Rudolph@klenzoidinc.com)  
[klenzoidinc.com](http://klenzoidinc.com)

**Latsha Davis & McKenna, PC**

David Marshall, Partner  
[dmarshall@ldylaw.com](mailto:dmarshall@ldylaw.com)  
[ldylaw.com](http://ldylaw.com)

**LW Consulting, Inc.**

Rodney Farley, Director and VP of Post  
Acute Care Services  
[rfarley@lw-consult.com](mailto:rfarley@lw-consult.com)  
[www.lw-consult.com](http://www.lw-consult.com)

**McKesson Medical-Surgical**

Paul Bombaski, Account Manager  
[paul.bombaski@mckesson.com](mailto:paul.bombaski@mckesson.com)  
[mms.mckesson.com](http://mms.mckesson.com)

**MobilexUSA**

Jim Papeika, Sales/Account Manager  
[jim.papeika@mobilexusa.com](mailto:jim.papeika@mobilexusa.com)  
[mobilexusa.com](http://mobilexusa.com)

**Novaerus**

Kyle Luetkemeyer, Senior Account  
Manager  
[kluetkemeyer@novaerus.com](mailto:kluetkemeyer@novaerus.com)  
[novaerus.com](http://novaerus.com)

**Optum**

Laura Mough, Assistant Director of  
Network Contracting  
[laura\\_mough@optum.com](mailto:laura_mough@optum.com)  
[optum.com](http://optum.com)

**Partners Pharmacy**

Brian Cannone, Regional Sales Director  
[Brian.Cannone@partnerspharmacy.com](mailto:Brian.Cannone@partnerspharmacy.com)  
[partnerspharmacy.com](http://partnerspharmacy.com)

**PELICAN Insurance, RRG**

Andrew Smith, Risk Control Specialist/  
PELICAN Marketing Specialist  
[asmith@pacounties.org](mailto:asmith@pacounties.org)  
[pacounties.org/Insurance/PELICAN/  
Pages/default.aspx](http://pacounties.org/Insurance/PELICAN/Pages/default.aspx)

**PA Health & Wellness**

Keri L. Harmicar, Manager, Community  
Engagement  
[keri.l.harmicar@pahealthwellness.com](mailto:keri.l.harmicar@pahealthwellness.com)  
[pahealthwellness.com](http://pahealthwellness.com)

**PharmScript, LLC**

Jamie Billings, Business Development/  
Education Liaison  
[jbillings@pharmscript.com](mailto:jbillings@pharmscript.com)  
[pharmscript.com](http://pharmscript.com)

**Phoebe Services Pharmacy**

Anastasia Lawrence, Pharmacy Business  
Development, Performance Assurance  
[alawrence@phoebe.org](mailto:alawrence@phoebe.org)  
[phoebepharmacy.org](http://phoebepharmacy.org)

**Physician's Mobile X-Ray**

Rian Bender, Director of Sales and  
Marketing  
[rbender@pmx-ray.com](mailto:rbender@pmx-ray.com)  
[pmx-ray.com](http://pmx-ray.com)

**Premier Therapy, LLC**

Scott Slipko, Business Development  
Manager  
[sslipko@embracepremier.com](mailto:sslipko@embracepremier.com)  
[embracepremier.com](http://embracepremier.com)

**RehabCare**

Randy Wadley, Director of Business  
Development  
[randolph.wadley@rehabcare.com](mailto:randolph.wadley@rehabcare.com)  
[rehabcare.com](http://rehabcare.com)

**Select Rehabilitation, LLC**

Josh Royston, Director of Business  
Development  
[selectrehab@selectrehab.com](mailto:selectrehab@selectrehab.com)  
[selectrehab.com](http://selectrehab.com)

**Standard Textile**

Paul Kantrowitz, Textile Consultant,  
Sales  
[pkantrowitz@standardtextile.com](mailto:pkantrowitz@standardtextile.com)  
[standardtextile.com](http://standardtextile.com)

**UPMC Community HealthChoices**

Danielle Wachter, Network Manager  
[upmchealthplan.com/chc](http://upmchealthplan.com/chc)

**Wound Healing Solutions**

Anthony Fardella, Marketing Manager  
[anthony@wounds.us](mailto:anthony@wounds.us)  
[wounds.us](http://wounds.us)

**Participating vendors listed are up-to-date as of April 2, 2018**

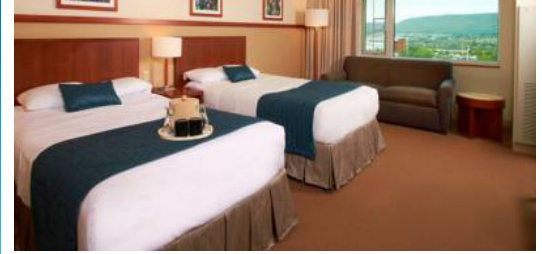

## The Penn Stater Hotel and Conference Center

**W**hen you are looking for a perfect hotel in State College, look no further than The Penn Stater Hotel and Conference Center. The Penn Stater is just minutes away from Penn State's University Park Campus, offering you quick and easy shuttle access to everything the university has to offer. The hotel features 300 guest rooms and suites complete with all the amenities you need for a relaxing and productive stay.

**CHECK-IN: 11 a.m. CHECK-OUT: 4 p.m.**

### ON-SITE DINING

Enjoy a meal at one of The Penn Stater's two in-hotel restaurants. Legends is a Penn State-themed pub with a full bar, and The Gardens offers a unique Americana menu and a popular Sunday brunch. Both restaurants are open daily for your dining pleasure.

### ROOM FEATURES

- Complimentary high-speed wireless internet access
- Workspace with data ports
- Flat-screen HDTV, mini-refrigerator
- Keurig coffeemaker
- HDMI cable for peripheral devices
- Hairdryer
- Iron and ironing board
- 100% smoke-free rooms

### ADDITIONAL AMENITIES

- Gift shop
- Valet services such as car parking and dry cleaning
- Complimentary parking & shuttle service, including airport transportation
- Fax and copy services
- Fitness center HDMI cables available in select rooms
- Whirlpool, lap pool

## Welcome to State College!

**S**tate College is a home rule municipality in Centre County in the Commonwealth of Pennsylvania. It is the largest designated borough in Pennsylvania. It is the principal borough of the six municipalities that make up the State College Metropolitan Statistical Area, the largest settlement in Centre County and one of the principal cities of the greater State College-DuBois. In the 2010 census, the borough population was 42,034 with approximately 105,000 living in the borough plus the surrounding townships often referred to locally as the "Centre Region." Many of these Centre Region communities also carry a "State College, PA" address although are not part of the borough of State College.

State College is a college town, dominated economically and demographically by the presence of the University Park campus of the Pennsylvania State University (Penn State). Though "Happy Valley" is another often used term to refer to the State College area, the term also includes the borough and the townships of College, Harris, Patton, and Ferguson.

Source: [https://en.wikipedia.org/wiki/State\\_College,\\_Pennsylvania](https://en.wikipedia.org/wiki/State_College,_Pennsylvania)



# Out & Around Town



## GROCERY & SHOPPING

**Giant Food Store**  
2222 E College Ave  
(814) 861-2578

**Wegmans**  
345 Colonnade Blvd  
(814) 278-9000

**McLanahan's Grocery Store**  
116 S Allen St  
(814) 861-3530

**Trader Joe's**  
43 Patriot Ln  
(814) 234-2224

**Nittany Shopping Mall**  
2901 E. College Ave  
(814) 238-8037

## DINING

**Allen Street Grill**  
100 W College Ave  
(814) 231-4745

**Baby's Burgers and Shakes**  
131 S Garner St  
(814) 234-4776

**Corner Room**  
100 W College Ave  
(814) 237-3051

**Happy Valley Brewing Company**  
137 Elmwood St  
(814) 234-4406

**Harrison's Wine & Grill**  
1221 E College Ave  
(814) 237-4422

**Irving's Bagel Bakery and Cafe**  
110 E College Ave  
(814) 231-0604

**Otto's Pub & Brewery**  
2235 N Atherton St  
(814) 867-6886

**Tavern Restaurant**  
200 E. College Ave  
(814) 238-6116

**Sichuan Bistro**  
332 W College Ave  
(814) 234-1102

**Green Bowl**  
131 W Beaver Ave  
(814) 238-3961

**Herwigs Bistro**  
132 W College Ave  
(814) 272-0738

**Kaarma Indian Cuisine**  
120 E Beaver Ave  
(814) 238-8141

**Brothers Pizza & Pasta**  
53 Benner Pike  
(814) 234-4200

**Faccia Luna**  
1229 S Atherton St  
(814) 234-9000

**Home D Pizzeria & Microbrewery**  
1820 S Atherton St  
(814) 237-7777

**Inferno Brick Oven and Bar**  
340 E. College Ave  
(814) 237-5718

**Mad Mex**  
240 S Pugh St  
(814) 272-5656

# Second Level

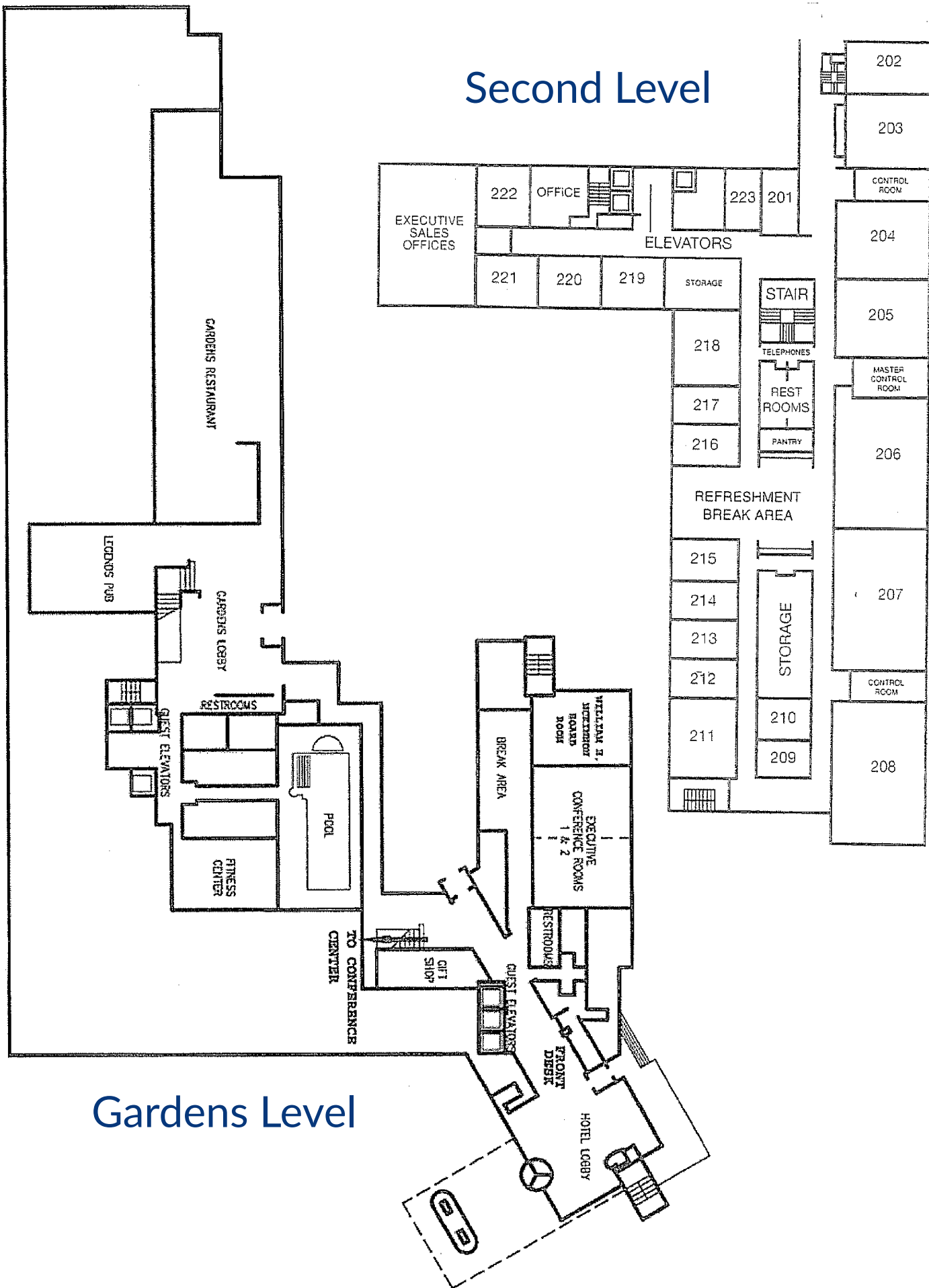

# Gardens Level

# Hotel Maps

## Main Level

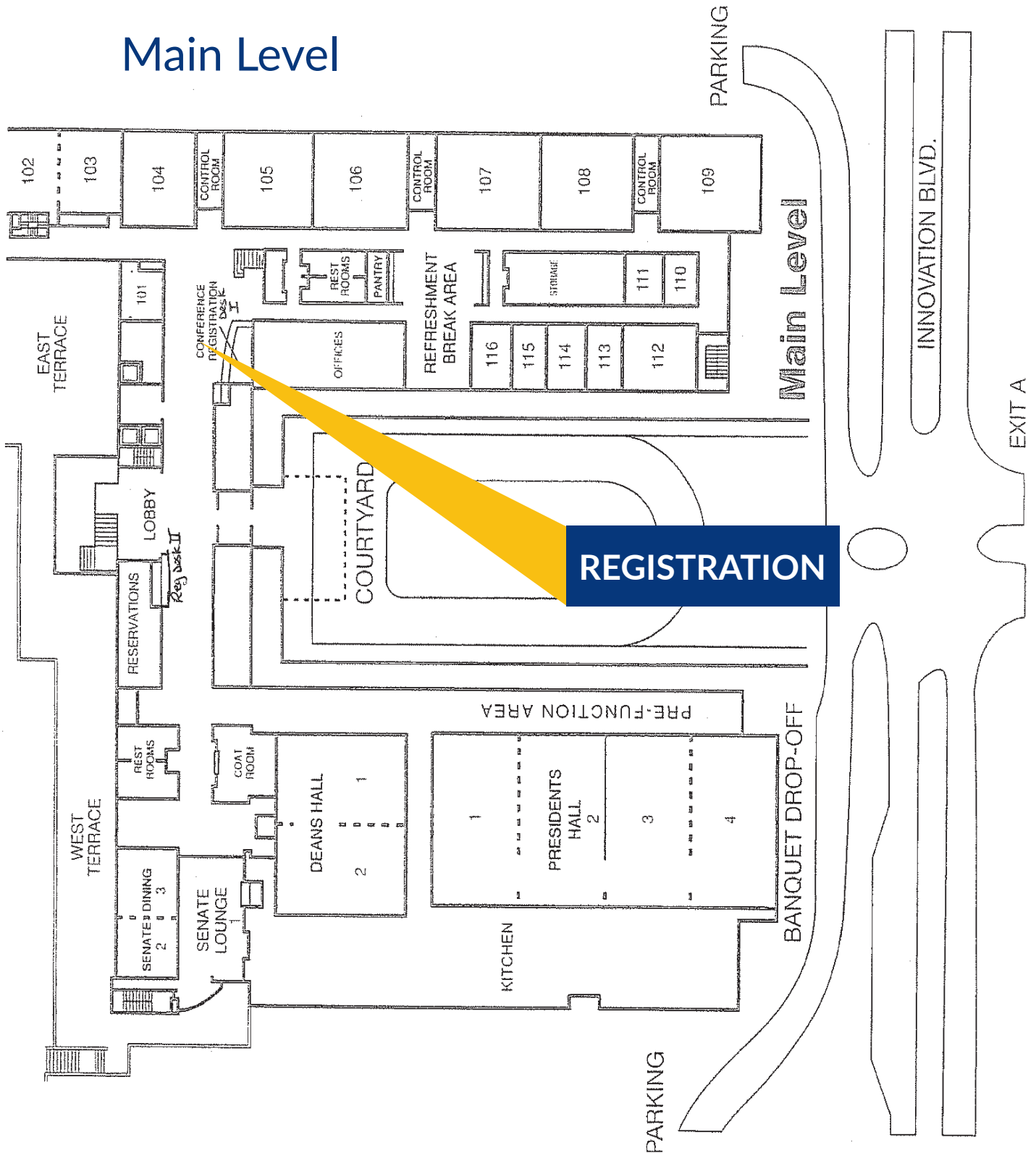



# Elwyn PHARMACY

A **BIOMATRIX**<sup>SpRx</sup> Company

*Prescriptions / Vaccines / Durable Medical Equipment*

TEL: 610-566-2226 FAX: 610-566-0521  
194 S. Middletown Road | Media, PA 19063

# Elwyn SPECIALTY CARE

A **BIOMATRIX**<sup>SpRx</sup> Company

*Specialty Medications & Long Term Care Services*

TEL: 610-545-6040 FAX: 610-545-6030  
3070 McCann Farm Dr | Suite 101 | Garnet Valley, PA 19060

We are a **URAC** and **ACHC** Accredited Pharmacy  
**FREE Overnight or Same Day Delivery!**

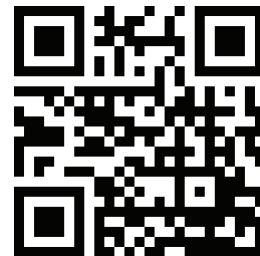

1-855-ELWYN-RX (359-9679)

***ElwynSpecialtyCare.com***



# Calmoseptine® Ointment

MULTIPURPOSE MOISTURE BARRIER

AVAILABLE WITHOUT A PRESCRIPTION

## LONG-LASTING PROTECTION

Protects and Helps Heal Skin Irritations

From:

- ✓ Incontinence of Urine or Diarrhea
- ✓ Feeding Tube Site Leakage
- ✓ Diaper Rash
- ✓ Wound Drainage
- ✓ Minor Cuts & Scrapes
- ✓ Burns / Irradiated Skin

TEMPORARILY RELIEVES DISCOMFORT & ITCHING

COST EFFECTIVE



Available in: 4 oz Tubes, 2.5 oz Tubes, 2.5 oz Jars, 20g Tubes and 1/8 oz Packets

Free samples included inside your 2018 PACAH Conference Tote Bag!

**Calmoseptine, Inc.**

16602 Burke Lane • Huntington Beach, California 92647 • U.S.A.

(800) 800-3405 • FAX (714) 840-9810

[www.calmoseptine.com](http://www.calmoseptine.com)

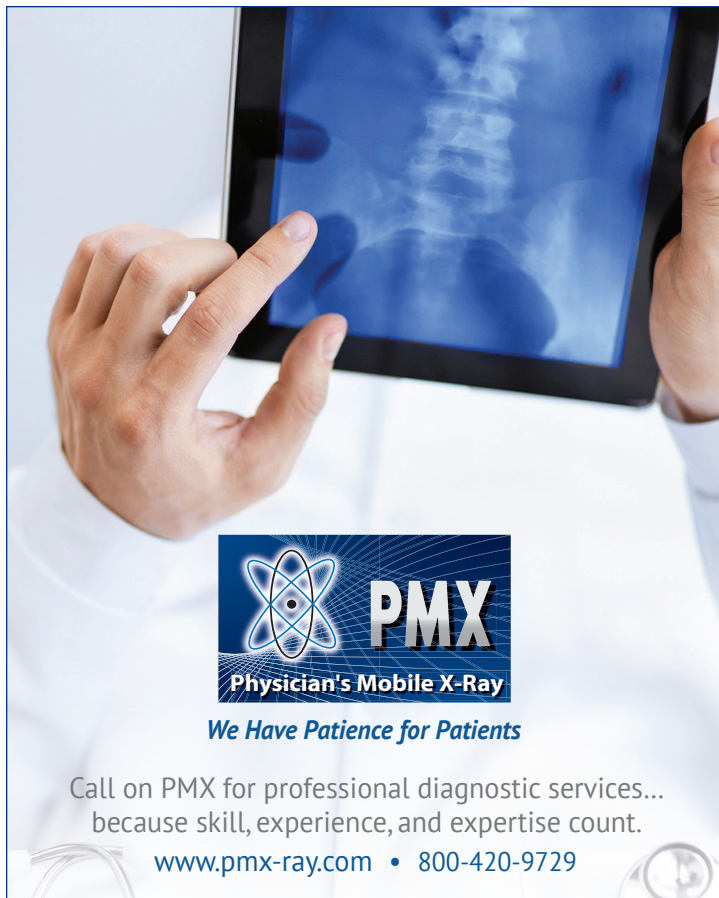

*We Have Patience for Patients*

Call on PMX for professional diagnostic services...  
because skill, experience, and expertise count.

[www.pmx-ray.com](http://www.pmx-ray.com) • 800-420-9729

DIGITAL  
RADIOGRAPHY

ULTRASOUND  
SERVICES

CARDIAC  
SERVICES

VASCULAR  
SERVICES

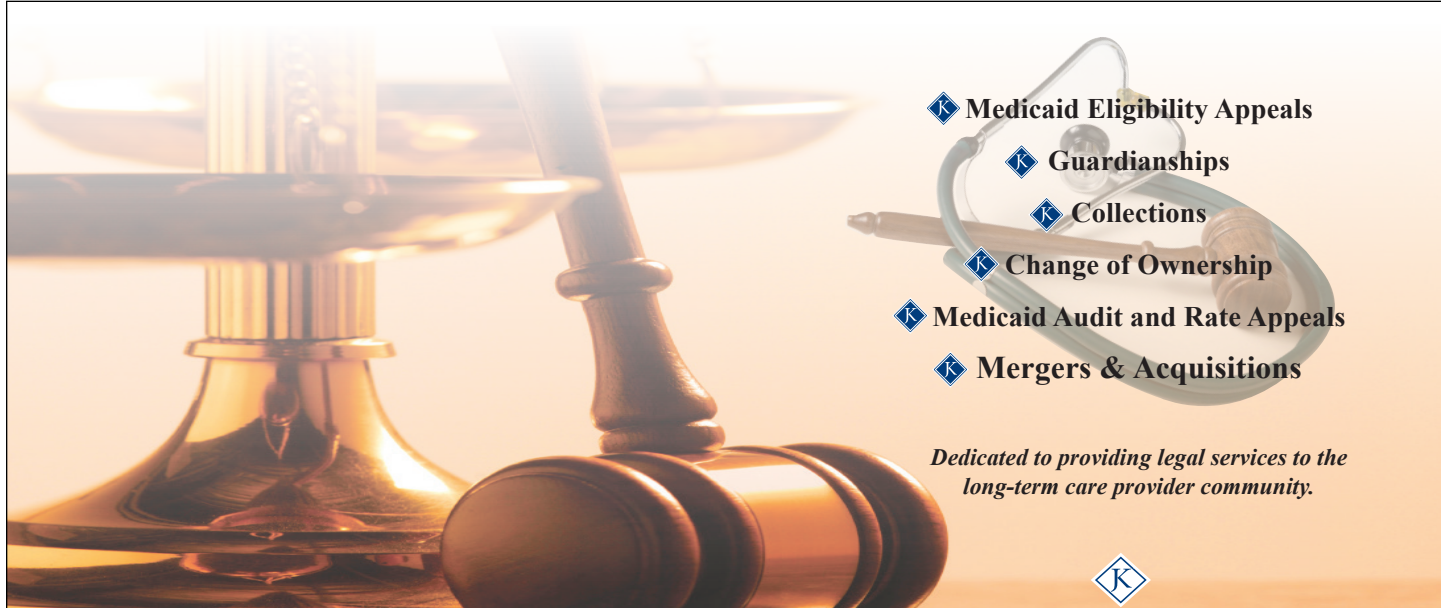

◆ Medicaid Eligibility Appeals

◆ Guardianships

◆ Collections

◆ Change of Ownership

◆ Medicaid Audit and Rate Appeals

◆ Mergers & Acquisitions

*Dedicated to providing legal services to the  
long-term care provider community.*



**KENNEDY, PC**  
LAW OFFICES

Website: [www.kennedypc.net](http://www.kennedypc.net)

Toll Free (877) 833-7100 • (717) 233-7100 • Fax (717) 233-7050

Locations:

P.O. Box 5100, Harrisburg, PA 17110-0100

1800 Chapel Avenue West, Suite 250, Cherry Hill, NJ 08002

482 Main Street, Harleysville, PA 19438

721 Melvin Avenue, Annapolis, MD 21401

911 Washington Avenue, Carnegie, PA 15106

John N. Kennedy, Esquire †\*§

Rodney A. Myer, Esquire †\*

Benjamin J. Glatfelter, Esquire †\*§

Laurie S. Kennedy, Esquire †

Laura E. Bayer, Esquire †

Casey L. Slotter, Esquire †

Steven E. Bernstein, Esquire †

Tamara A. Siegert, Esquire †

† Licensed in Pennsylvania

§ Licensed in Maryland

\* Licensed in New Jersey



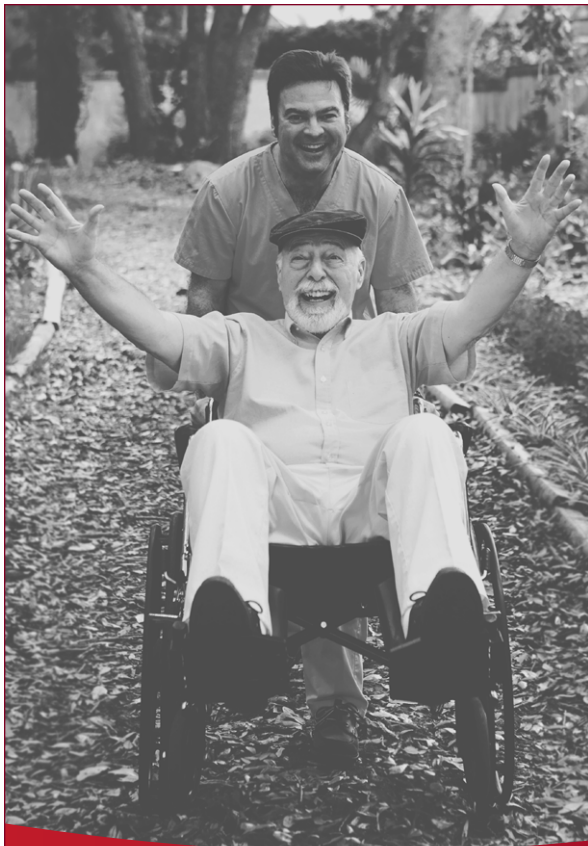

*Providing Therapy A Better Way*

At Functional Pathways, we've successfully navigated every industry change for the past 23 years.

With more change coming to long-term-care, it's more important than ever to partner with a strong rehab provider. Getting our patients better is our top priority — and it shows in our results. Functional Pathways provides outcomes, partnership, and innovation A Better Way through our training, clinical programming, and propriety software systems making our clients the top choice in their referral networks.

888.531.2204 • Follow Us on Facebook • [www.fprehab.com](http://www.fprehab.com)

## EXPERIENCING HEALTHCARE REGULATORY AND FINANCIAL PRESSURES?



### Proficient Resources for Strategic Success

- ◆ **PROACTIVE PREPAREDNESS**  
Skilled Nursing Regulatory Excellence  
Personal Care Home Regulatory Excellence
- ◆ **INVESTMENT AND DEVELOPMENT WITH TRAINING**



**877-311-0110**  
**[AffinityHealthServices.net](http://AffinityHealthServices.net)**



# LATSHA DAVIS & McKENNA



ATTORNEYS AT LAW

ldylaw.com

Delivering a broad spectrum of legal services to Pennsylvania's nonprofit post-acute providers since 1994.

1700 Bent Creek Blvd., Suite 140, Mechanicsburg, PA 17050  
T 717.620.2424 F 717.620.2444

350 Eagleview Blvd., Suite 100, Exton, PA 19341  
T 610.524.8454 F 610.524.9383



**Express Mobile Diagnostic Services, LLC**  
2030 Ader Road, Penn Township PA 156441.  
877.602.2847  
[www.expressmobilediagnostic.com](http://www.expressmobilediagnostic.com)

## Services We Offer:

### Digital Xray:

|                                    |                      |
|------------------------------------|----------------------|
| Fingers/Hand/Wrist                 | Hip/Pelvis           |
| Forearm/Elbow                      | Femur                |
| Humerus/Shoulder                   | Tib/Fib              |
| Clavicle                           | Knee                 |
| Scapula                            | Ankle/Foot/Toes      |
| Spine (Cervical, Thoracic, Lumbar) | Sacrum/ Coccyx       |
| Abdomen                            | Skull                |
| Chest/Ribs                         | Facial & Nasal Bones |
|                                    | Mandible             |

### Ultrasound:

Vascular- Venous (Upper, Lower) Carotid, Renal Vascular,  
Arterial (Upper, Lower), Ankle Brachial Index,  
Abdominal Vascular

**Cardiac:** Echocardiogram

### General:

|                                |                   |
|--------------------------------|-------------------|
| Abdomen<br>(Limited/ Complete) | Liver             |
| Breast                         | Aorta             |
| Pancreas                       | Prostate /Scrotal |
| Testicular                     | Renal             |
| Gallbladder/Bladder            | Thyroid           |

### Other Services:

|                  |                            |
|------------------|----------------------------|
| Bone Density     | Cardiac Telemetry (30 Day) |
| Pacemaker Checks | Holter Monitors (24-48)    |
| Sleep Studies    | EKG                        |

**Abdominal Aortic Aneurysm Screening**  
**Diabetic Baseline Testing**

**OB/GYN:** Pelvic, Trans-vaginal, Trimester 1, 2, and 3



UPMC Community HealthChoices is proud  
to support the **PACAH 2018 Spring Conference.**

[www.upmchealthplan.com/chc](http://www.upmchealthplan.com/chc)

**UPMC Community  
HealthChoices**



# GUARDIAN

Elder Care  
Management Services

**New!**

## We are here to support you!

Our experienced team of consultants have the benefit of observing multiple facilities, bringing you the knowledge that we gain across our organization. Our management support structure is based on the following “CORE” services:

- **Operations**
- **Clinical**
- **Financial**
- **Business Development**

Beyond these basic services, Guardian Elder Care has a long menu of services to choose if your facility requires more assistance:

- **Business Office Services** - Billing, Accounts Payable, Payroll, Financial Statements, & Cost Reporting
- **Nurse Practitioner Services**
- **Rehabilitation** - Physical, Occupational, and Speech Therapy contracting
- **Pharmacy Services**
- **Staffing Agency/ Staff Recruiting**
- **Home Health Care**
- **Home Care**
- **On-Staff Architect**
- **And more...**

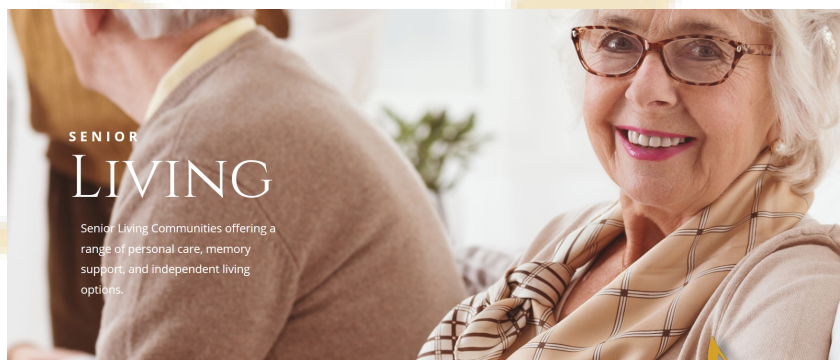

**Call Us... (814) 265-1164**





# Allstar Therapies

The Therapy You Need,  
The Results You Deserve.

- ★ Skilled Nursing rehabilitation
- ★ Home Care rehabilitation
- ★ Patient-centered continuity of care
- ★ Excellent clinical outcome reporting
- ★ Census development and marketing support
- ★ Home assessment program
- ★ Clinical pathways program



1-855-365-0308 | [www.allstartherapies.com](http://www.allstartherapies.com)

[www.actcpas.com](http://www.actcpas.com)

Why Choose  
**ACT?**



**270** professionals  
**8** offices  
**70** years of experience

**ACTION**  
for your  
business

Here's What Some of Our

## Clients Have to Say...

"ACT distinguished themselves on the basis of technical expertise, resource commitment, and value relative to the professional fees."

"I do not hesitate to contact them when I have an issue; they are a trusted business partner."

"In all of our interactions, ACT has been professional, responsive, and thorough in their approach."

"Their staff is amazingly consistent from year to year for the accounting industry. Their knowledge of Medicaid, Medicare, taxes, you name it, is top notch."



**Arnett  
Carbis  
Toothman** llp

CPAs & Advisors

800.452.3003

# OPPORTUNITY'S KNOCKING



## MEMBER BENEFITS

- Access to the PACAH Listserv and PACAH Newsletter
- Receipt of PACAH informational and educational emails
- Sponsorship opportunities at PACAH conferences
- Advertising space in PACAH's conference programs
- Discounted rates at our semi-annual vendor shows
- The ability to sit on PACAH committees
- Acknowledgement of your business as a partner of PACAH on our website
- Networking opportunities in a close-knit environment

## GROW YOUR BUSINESS - JOIN TODAY!

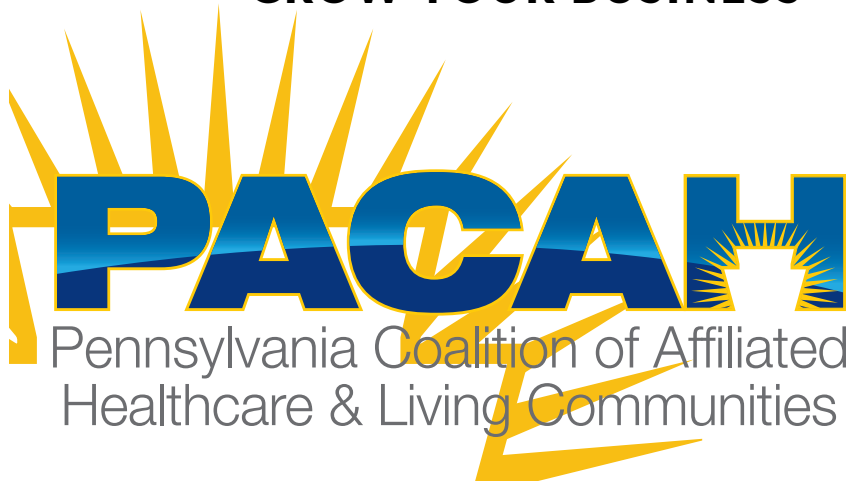

## CONTACT

**Kelly Andrisano**  
Executive Director  
[kandrisano@pacounties.org](mailto:kandrisano@pacounties.org)  
(717) 736-4740

**Kim Deline**  
Meeting & Marketing Manager  
[kdeline@pacounties.org](mailto:kdeline@pacounties.org)  
(717) 736-4741

[www.pacahpa.org](http://www.pacahpa.org)



Pennsylvania Coalition of Affiliated  
Healthcare & Living Communities



# 2018 Spring Conference

Full Conference agenda begins on page 30

... AT A GLANCE

## TUESDAY, APRIL 24, 2018

|                      |                                     |
|----------------------|-------------------------------------|
| 9 a.m. - 6 p.m.      | Registration                        |
| 10 a.m. - 12:30 p.m. | Executive Board Meeting             |
| 1 - 4:15 p.m.        | PELICAN Training                    |
| 2:30 p.m.            | Afternoon Break                     |
| 2 - 4 p.m.           | Fiscal Management Committee Meeting |
| 6 - 10 p.m.          | Welcome Party                       |

## WEDNESDAY, APRIL 25, 2018

|                        |                                  |
|------------------------|----------------------------------|
| 7 a.m. - noon          | Registration                     |
| 7 - 8 a.m.             | Continental Breakfast            |
| 8 - 9:15 a.m.          | Keynote Speaker, Jake Poore      |
| 9:15 - 9:30 a.m.       | Meet & Greet with Jake           |
| 9:30 a.m. - 10:30 a.m. | Educational Sessions             |
| 10:30 a.m.             | Morning Break                    |
| 10:30 a.m. - 1 p.m.    | Educational Sessions             |
| noon - 1:30 p.m.       | Golf Luncheon                    |
| 1:30 p.m.              | 2018 Spring Golf Outing          |
| 1:30 - 4:30 p.m.       | 2018 Spring Wine Outing          |
| 5 - 7 p.m.             | New Member & Attendee Happy Hour |





## THURSDAY, APRIL 26, 2018

|                         |                                     |
|-------------------------|-------------------------------------|
| 7 a.m. - 3:30 p.m.      | Registration                        |
| 7 - 8 a.m.              | Continental Breakfast               |
| 8 - 10:15 a.m.          | Educational Sessions                |
| 10:15 a.m.              | Morning Break                       |
| 10:30 - 11:30 a.m.      | Educational Sessions                |
| 11:45 a.m. - 12:45 p.m. | PELICAN Luncheon & Business Meeting |
| 1 - 2:30 p.m.           | Educational Sessions                |
| 2:30 p.m.               | Afternoon Break                     |
| 2:45 - 3:45 p.m.        | Educational Sessions                |
| 3:45 - 6 p.m.           | PACAH 2018 Spring Vendor Show       |
| 8:30 - 11:30 p.m.       | Conference Party                    |

## FRIDAY, APRIL 27, 2018

|                         |                       |
|-------------------------|-----------------------|
| 7 - 11:30 a.m.          | Registration          |
| 7 - 8 a.m.              | Continental Breakfast |
| 8 - 10 a.m.             | Educational Sessions  |
| 10 a.m.                 | Morning Break         |
| 10:15 a.m. - 12:30 p.m. | Educational Sessions  |

# PACAH 2018 SPRING CONFERENCE AGENDA

## **CREDIT APPROVAL NOTICE**

The 2018 spring educational offerings have been approved by the National Continuing Education Review Service (NCERS) of the National Association of Long Term Care Administrator Boards (NAB) for 25.25 total credit hours for Nursing Home Administrators and 25.25 total credit hours for Assisted Living Residence Administrators. (16.75 max)

PACAH has been approved for 25.25 total credit hours for Licensed Personal Care Home Administrators. (16.75 max)

This program offers 25.25 total credit hours fulfilling the requirements of the Pennsylvania State Board of Nursing. (16.75 max)

PACAH is registered with the Pennsylvania State Board of Accountancy and is approved for 13.5 total credit hours. (11.5 max)

This program has been approved for fulfilling the continuing education requirements of the Certifying Board for Dietary Managers (CBDM) for 25.25 total credit hours for CDM, CFPP certified individuals. (16.75 max)

## **CEU LEGEND**

NHA - Nursing Home Administrators  
RC/AL - Assisted Living Administrators  
PC - Personal Care Home Administrators

RN - Nursing  
CPE - Fiscal  
CBDM - Dietary



## **CONTINUING EDUCATIONAL CREDIT TRACKING**

PACAH will no longer issue paper certificates as proof of attendance.

All educational credits will be electronically tracked with barcode scanners. You will see a barcode located at the bottom of your name badge - a barcode that is unique to you. Please look for PACAH board or staff members that are holding barcode scanners as you enter and exit session rooms.

In order to accurately track your session attendance, you are required to have your barcode scanned prior to all sessions. At the end of each session, you are again required to have your barcode scanned upon departure from the session room. Failure to have your barcode scanned both prior to and after sessions will result in inaccurate session tracking and the risk the loss of credit hours earned.

Approximately one month post-conference, you will receive information regarding the retrieval of your certificate of attendance electronically.

Please visit PACAH's registration desk if you have any additional questions.

## **EVALUATIONS**

Please take a few moments to complete the evaluation form found in your registration packet. PACAH's Education Committee appreciates and relies on your comments and ideas in order to further improve our upcoming conferences, webinars, and training sessions.

When you have completed your evaluation, please submit the form to PACAH's registration area or submit to Kim Deline via email or mail:

PACAH  
PO Box 60769  
Harrisburg, PA 17106-0769  
[kdeline@pacounties.org](mailto:kdeline@pacounties.org)

## TUESDAY, APRIL 24, 2018

### REGISTRATION

9 a.m. – 6 p.m.

Registration Desk One

### EXECUTIVE BOARD MEETING AND LUNCH

10 a.m. – 12:30 p.m.

Room 218

### GENERAL SESSION - "PELICAN TRAINING" – SPONSORED BY PELICAN INSURANCE, RRG

1 – 4:15 p.m.

Room 207

NHA – 3

RC/AL - 3

PC - 3

RN – 3

CBDM - 3

### "CMS EVENT PREPAREDNESS GUIDELINES AND NATURAL DISASTER EMERGENCY PREPAREDNESS"

During this session the learner will be presented an overview of the CMS Emergency Preparedness Rule. The learner will understand the general requirements of this rule and how best to meet the requirements. The best way to meet a majority of the rule is for facilities to participate in their regional healthcare coalition. The learner will be presented with the Pennsylvania Healthcare Coalition program and how to participate, benefits and examples. Case studies of past emergency events will be presented to the audience to provide examples of best practices, lessons learned, and to provide additional emphasis to the previous topics of CMS and Coalitions.

*Mark Ross, CHEP, Regional Manager, Emergency Preparedness  
Hospital & Healthsystem Association of Pennsylvania*

### AFTERNOON BREAK - SPONSORED BY PELICAN INSURANCE, RRG

2:30 p.m.

Second Floor Break Area

### FISCAL MANAGEMENT COMMITTEE MEETING

2 – 4 p.m.

Room 218

### WELCOME PARTY - SPONSORED BY COMPLETE HEALTHCARE RESOURCES- EASTERN, INC.

6 – 7 p.m. - Cocktail Hour

7 – 10 p.m. - Dinner Buffet

Presidents Hall 1

Join PACAH and Complete Healthcare Resources - Eastern, Inc. as we kick-off PACAH's 2018 Spring Conference! Be sure to stop by for an evening complete with hors d'oeuvres, dinner, open bar, and great conversation with fellow attendees!

## WEDNESDAY, APRIL 25, 2018

### REGISTRATION

7 a.m. – noon

Registration Desk One



## **CONTINENTAL BREAKFAST - SPONSORED BY HARRIS MEDICAL, LLC**

7 – 8 a.m.

Prefunction Presidents Hall 1

## **KEYNOTE SPEAKER, JAKE POORE - "THE POWER OF CONNECTIONS" AND "THE LEADER'S ROLE IN BUILDING AND SUSTAINING EXCEPTIONAL PATIENT EXPERIENCES" - SPONSORED BY PELICAN INSURANCE, RRG**

8 – 9:15 a.m.

Presidents Hall 1

NHA – 1.25

RC/AL - 1.25

PC - 1.25

RN – 1.25

CBDM - 1.25

### **"THE POWER OF CONNECTIONS"**

Whether we realize it or not, patients today are consumers. Your clinical reputation gets them in the front door, but what gets them to come back? And what will earn a lifetime of loyalty, especially if you are not the lowest cost or most convenient provider?

If we could walk in the patient's shoes, we would discover that their entire experience is made up of many opportunities to make connections, where each step and every employee interaction matters. While random acts of kindness are good, the real key to improving patient experiences and building loyalty lies in your ability to empower employees to intentionally and consistently orchestrate connections, rather than leaving them to chance. The secret is to take random acts of kindness and hard wire them so those moments - those connections - become business as usual. Ultimately, we must apply the same rigor to service excellence as we do to clinical expertise and we do this through the power of connections.

Go with Jake as he shares both the best practices and lessons learned that will arm and empower every member of your care team with the tools they need to intentionally orchestrate patient connections, improve the patient experience, and build loyalty.

### **"THE LEADER'S ROLE IN BUILDING AND SUSTAINING EXCEPTIONAL PATIENT EXPERIENCES"**

Whether you have a title or not, everyone is a leader. We all have a circle of influence on others. Great leaders not only take care of our patients and customers, they inspire their colleagues and associates. Participants will gain knowledge of both the approach and the tools successful leaders use to elevate experiences to world-class status.

In this dynamic presentation, Jake will share a powerful but simple tool that weaves together the two levels of every patient interaction and how, when those levels are balanced, trust is established and reinforced between patients and caregivers.

As faculty for the American College of Healthcare Executives, a former Disney leader, and President and Chief Experience Officer of Integrated Loyalty Systems, Jake is the leading expert on creating world-class employee and patient experiences. Join us as he shares his knowledge and inspires!

*Jake Poore, President & Chief Experience Officer  
Integrated Loyalty Systems*

## **MEET & GREET WITH JAKE POORE**

9:15 - 9:30 a.m.

Prefunction Presidents Hall 1

## **GENERAL SESSION - "2018 REGULATORY HAPPENINGS"**

9:30 – 10:30 a.m.

Room 205

NHA – 1

RC/AL – 1

PC – 1

RN – 1

CPE - 1

CBDM - 1

This session will examine the recent changes in federal and state enforcement philosophies and sanctions. We will also explore strategies for improving survey outcome. Through collaborative discussions, attendees will share recent experiences and survival techniques.

*Paula Sanders, Esq., Principal & Chair, Healthcare Practice  
Post & Schell, P.C.*

## **MORNING BREAK**

10:30 a.m.

Second Floor Break Area

## **BREAKOUT SESSION - "COMMUNITY HEALTHCHOICES: LESSONS LEARNED IN PHASE 1 NEGOTIATION"**

10:45 - 11:45 a.m.

Room 205

NHA – 1

RC/AL – 1

PC – 1

RN – 1

CPE - 1

CBDM – 1

Phase 1 of Community HealthChoices (CHC) began in the Southwest Zone on January 1, 2018. Before this implementation, there were months of negotiation with the CHC Managed Care Organizations (MCOs) to finalize the service agreements with facilities. DHS delayed Phase 2 and 3 to learn from the Phase 1 rollout and allow time to make any necessary adjustments before implementing further phases. Facilities should use this time to do the same. The new start dates for the other phases are January 1, 2019 for the Southeast and January 1, 2020 for the Northwest, Northeast, and Lehigh/Capital Region. If your facility is in Phase 2 or 3, it is time to begin preparing for the process of negotiating with the selected MCOs.

In attending this session, you will:

- Learn what the negotiation process will be, including expectations and time frames
- Discover what issues the MCOs may be willing to negotiate on and what they will not
- Anticipate what obstacles you may face
- Hear about how all three MCOs handled rates
- Understand who and what you need to bring to the table to be most effective

*Cynthia A. Haines, Esq., Principal  
Post & Schell, PC*

## **BREAKOUT SESSION - "ACO SUCCESS: THERAPY CAN HELP"**

10:45 - 11:45 a.m.

Room 206

NHA – 1

RC/AL – 1

PC – 1

RN – 1

CBDM – 1

An Accountable Care Organization (ACO) is a group of doctors, hospitals, and other healthcare providers who collaborate their efforts with the goal of delivering high-quality care to Medicare patients. The goal for this level of care coordination is to improve communication and collaboration among all members of a patient's healthcare team, ensuring that patients receive the best care at the most appropriate time. ACO structure also attempts to eliminate unnecessary or duplicate services by forcing providers to operate as part of a team. To become a valued member of the ACO, skilled nursing facility (SNF) providers are strongly encouraged to present dashboards that paint a certain picture, which requires a team of collaboration. This course is designed to describe the main SNF focuses and a successful inter-disciplinary program that achieves the desired results for both the provider and their patients.

At the conclusion of our presentation, the participant will be able to:

- Describe the goals and characteristics of a successful ACO
- Understand the critical benchmarks necessary to flourish in the ACO environment
- Identify an interdisciplinary team approach and best practices needed to be successful within the ACO

*Heather Meadows, CCC/SLP/Executive Director of PA, Certified Dementia Practitioner (CDP)*

*Ginny Grant, PT, Area Director*

*Rebecca Rumsky, COTA/L, Program Director*

*Premier Therapy, LLC*

## **BREAKOUT SESSION - "CREATING A CUSTOMIZED VERSION OF THE 'HOUSEHOLD MODEL' AT YOUR FACILITY"**

**10:45 - 11:45 a.m.**

**Room 207**

NHA – 1

RC/AL – 1

PC – 1

RN – 1

CBDM – 1

The household model has become the prevalent paradigm in the industry, but does it seem unattainable within your physical plant issue or care culture?

This session will explore ways to create households under difficult circumstances, will bring new ideas from other cultures and housing types, and will explore the social unit that is the household itself. Many facilities have a physical plant arrangement that dates back into the 70s, 80s, or 90s when senior housing and care was very different. The culture of aging has changed, and with it must change both care attitudes and living environments.

Learning objectives:

- Understanding what a household really is
- Gaining ideas from other approaches to housing and care
- Reconsidering realistic household size versus staffing and budget
- Looking at practical ways to create better environments in aging facilities

We will also touch on the nature of households as family units or circles of friends as well as look at care models from Canada, Europe, and even the VA, and get ideas from other housing models, all to take a fresh look at your own opportunities to improve your culture of care.

*Thomas S. Grden, AIA, Principal*

*Tracey Graham, RN, MSN, MSM, CEN NP-C, DNP, Senior Healthcare Strategist*

*Renz A. Weinmann, A.I.A., LEED AP BD&C, Associate Architect*

*Stantec Architecture*

## **GENERAL SESSION - "OLTL UPDATE AND FISCAL OFFICER'S GROUP MEETING"**

**noon - 1 p.m.**

**Presidents Hall 1**

NHA – 1

RC/AL - 1

PC - 1

RN – 1

CPE - 1

CBDM - 1

The Department of Human Services' (DHS) policy manager for the Office of Long-Term Living (OLTL) will report on current initiatives undertaken by her office. This will include an update on Community HealthChoices (CHC) in Pennsylvania with discussion on implementation in the Southwest, any ongoing issues, payment of claims, etc. Other initiatives being undertaken by OLTL and DHS will also be discussed as well as the 2018-2019 FY Budget. PACAH's Fiscal Officer's Group (FOG) will also meet during the session and be joined by OLTL's finance department. Among the topics to be discussed will be the state budget, status of rate payments, the nursing facility assessment, the Intergovernmental Transfer (IGT), the MDOI payments, and other issues impacting fiscal operations.



Edward P. Frigo, Director, Fiscal Services  
Premier Healthcare Resources

Peggy Morningstar, Esq., CPA, CFE, Chief Financial Officer  
Department of Human Services, Office of Long-Term Living

Judith Patrick, Policy Manager  
Bureau of Policy and Regulatory Management, Department of Human Services, Office of Long-Term Living

**PACAH 2018 SPRING GOLF OUTING - SPONSORED BY UPMC COMMUNITY HEALTHCHOICES**

noon – 1:30 p.m. - Lunch  
1:30 p.m. - Shotgun Start  
Mountain View Golf Course

Lunch will be available beginning at noon. Tee time is at 1:30 p.m. Players will be responsible for their own transportation to and from the Penn Stater Hotel and Conference Center and Mountain View Golf Course.

**PACAH 2018 SPRING WINE OUTING - SPONSORED BY AFFINITY HEALTH SERVICES & FUNCTIONAL PATHWAYS**

1:15 p.m. - Meet in the hotel lobby  
1:30 p.m. - Coach bus departs the Penn Stater  
Mt. Nittany Vineyard & Winery

**SOLD OUT**

Affinity Health Services and Functional Pathways are taking us on a relaxing afternoon, among the picturesque landscape of Mt. Nittany Vineyard and Winery, where we will sample their wines and enjoy a light lunch. Coach bus transportation will be provided on a first come, first serve basis to those who have registered in advance. We will depart the Penn Stater promptly at 1:30 p.m. and depart Mt. Nittany Vineyard & Winery at approximately 4 p.m.

**NEW MEMBER & CONFERENCE ATTENDEE HAPPY HOUR - SPONSORED BY EXPRESS MOBILE DIAGNOSTICS, LLC**

5 - 7 p.m.  
Deans Hall 1

PACAH and Express Mobile Diagnostics welcome our new members and first-time attendees for cocktails and hors d'oeuvres...on us! All conference attendees are welcome and encouraged to attend!

## THURSDAY, APRIL 26, 2018

**REGISTRATION**

7 a.m. – 3:30 p.m.  
Registration Desk One

**CONTINENTAL BREAKFAST - SPONSORED BY GARDARX, LLC**

7 – 8 a.m.  
Prefunction Presidents Hall 1

**GENERAL SESSION - "PACAH BUSINESS MEETING & LEGISLATIVE UPDATE/COMMUNITY HEALTHCHOICES: THE SOUTHWEST EXPERIENCE"**

8 - 9 a.m.  
Presidents Hall 1  
NHA – 1  
RC/AL – 1  
PC – 1  
RN – 1  
CPE- 1  
CBDM – 1

Following a brief business meeting and update, PACAH will host a Community HealthChoices (CHC) panel discussion for attendees. The panel will feature skilled nursing facility representatives and businesses from the Southwest region who can provide some insights and recommendations regarding the implementation of Community HealthChoices in the Southwest as well as tips and suggestions for facilities in the other two implementation zones. Hear from actual providers on their experiences with transportation, claims submission, service coordinators, pre-authorization, auto-enrollment, 30 day plans, dental services, and other specific CHC issues. There will be time for discussion and questions from attendees to ensure that the most timely topics are addressed. The session will be moderated by Kelly Andrisano, PACAH Executive Director, and Mike Kessler and Edward Klik of Arnett Carbis Toothman, LLP.

*Kelly Andrisano, J.D., Executive Director  
PACAH*

*Michael J. Kessler, III, CPA, CGMA, Senior Manager - Health Care Services  
Arnett Carbis Toothman, LLP*

*Edward A. Klik, Jr., Partner - Health Care Services, Director of Health Care Reimbursement Services  
Arnett Carbis Toothman, LLP*

### **BREAKOUT SESSION - "WHAT IS THE REAL AND ONGOING IMPACT OF THE MDS IN YOUR FACILITY?"**

9:15 - 10:15 a.m.

Room 206

NHA - 1

RC/AL - 1

PC - 1

RN - 1

CPE - 1

CBDM - 1

Minimum Data Set (MDS) assessments continue to be a focus now and in the future. Attendees will achieve a basic understanding of MDS scheduling, accuracy, and the impact of MDS documentation on various federal programs' reimbursement system, including, but not limited to quality measures, Five-Star Report, Value-Based Purchasing, and Quality Reporting Program. We will also cover what Department of Health (DOH) surveyors will be reviewing from the MDS assessments during your facility survey.

The session will review the following:

- The importance of MDS assessment accuracy
- DOH Survey, Federal Regulations 483.20 Resident Assessments pertaining MDS assessments, scheduling, accuracy, completion, and submission
- Review Quality Reporting Program (QRP) and Value-Based Purchasing (VBP)
- Accurate identification of the MDS assessments that would identify issues/areas for each of the programs
- MDS' effect on the quality measures and how that impacts your facility and Five-Star Rating calculations
- Review what MDS assessments are used in Payroll Based Journal (PBJ) census calculation

*Margaret Turner, RN, RAC-CT, Senior Director, Clinical Reimbursement*

*Lisa Gourley, RN, RAC-CT 3.0, Clinical Reimbursement Specialist*

*Kara Schilling, RN, RAC-CT 3.0, Clinical Reimbursement Specialist*

*Complete HealthCare Resources- Eastern, Inc.*

### **BREAKOUT SESSION - "CYBER SECURITY IN HEALTH CARE - WHAT YOU NEED TO KNOW TO PROTECT YOUR ORGANIZATION"**

9:15 - 10:15 a.m.

Room 207

NHA - 1

RC/AL - 1

PC - 1

RN - 1

CPE - 1

CBDM - 1

Security of patient data is becoming even more of an issue as security breaches are often a daily news item. Cyber security is an important defense against malicious outsiders or insiders. A good cyber security defense contains multiple facets including technical, physical, and administrative controls. This session will cover cyber security basics, risk, prevention, preparation, and response in a healthcare environment.

Session objectives:

- Explain cyber security basics and how it relates to HIPAA regulations
- Describe cyber-attack techniques
- Identify cyber-attack prevention, preparation and response basics
- List cyber vulnerabilities

Audience Benefits:

- Understand cyber security basics
- Understand a practical approach for planning, managing, achieving and maintaining cyber security

*John P. DiMaggio, Co-Founder & CEO  
BlueOrange Compliance*

### **MORNING BREAK - SPONSORED BY ABSOLUTE REHABILITATION**

10:15 a.m.

Second Floor Break Area

### **BREAKOUT SESSION - "DOH SANCTIONS: A NEW ERA"**

10:30 - 11:30 a.m.

Room 206

NHA - 1

RC/AL - 1

PC - 1

RN - 1

CPE - 1

CBDM - 1

As of December 2017, nursing facilities have begun to see a significant increase in the amount of civil money penalties imposed by the Pennsylvania Department of Health (DOH). In some instances, the civil money penalties are in the six-figure range, which is excessive and unprecedented as compared to fine amounts that DOH has issued in previous years. It appears that DOH has revamped the framework or methodology it utilizes in determining the amount of civil money penalties, which has resulted in civil penalties that are much more punitive in nature. To avoid the imposition of civil penalties and other DOH sanctions, nursing facility providers will need to ensure compliance with the long-term care Final Rule and be familiar with the revisions to Appendix PP of the State Operations Manual, which revised interpretative guidance became effective November 28, 2017, along with the Phase 2 requirements of participation. This session will address strategies and best practices for nursing facilities to consider in preparing for a survey and will also provide a brief overview of the new long-term care survey process. The presenter will also explore the appeal options available to nursing facility providers in responding to an adverse survey.

*Tanya Daniels Harris, Esq., Senior Attorney  
Latsha Davis & McKenna, P.C.*

### **BREAKOUT SESSION - "WHY EVERY NURSING FACILITY SHOULD BE OFFERING TELEMEDICINE FOR ITS RESIDENTS"**

10:30 - 11:30 a.m.

Room 207

NHA - 1

RC/AL - 1

PC - 1

RN - 1

CPE - 1

CBDM - 1

Telemedicine has proven itself as a safe, effective, and viable service for improving access to care for nursing



facility residents and as a valuable tool for preventing avoidable skilled nursing facility (SNF) to hospital transfers and emergency room visits. This session will elaborate on the need for, the benefits of, and the positive economic impact telemedicine can have on an individual nursing facility. The session will also differentiate non-rural from rural SNFs and identify the significant operational and financial differences between them.

Today's health care system is rapidly changing, and nursing home operators must also change with the times. The historical practice pattern of physicians sending residents to the hospital with any significant change of medical condition is no longer acceptable. This historic practice, known as "The Default Factor," is being replaced with the use of telemedicine which provides access to a virtual physician at the bedside capable of conducting an in-depth evaluation of the resident's medical condition and accurately determining if a resident's condition justifies being admitted to the hospital or if the resident can and should remain and be cared for in the SNF.

Learning Objectives will provide attendees with an understanding of:

- What "telemedicine" means for SNFs and the various services and benefits it can offer your residents and your facility
- How utilizing a virtual physician can be integrated and accepted by your medical director and other practicing physicians
- Implications of utilizing telemedicine, specifically: What is the real cost; does it require cash outlay or will it generate a financial return for my facility; can it improve my Resource Utilization Group (RUG) Scores and Five-Star Quality Rating?
- How does telemedicine differ for rural versus non-rural facilities?
- How to conduct a "self-evaluation" of your SNF to determine if telemedicine is right for your facility

*John Whitman, MBA, NFA*

*Founder & Executive Director, The TRECS Institute*

*Adjunct Professor, The Wharton School, University of Pennsylvania*

### **PELICAN INSURANCE, RRG LUNCHEON & BUSINESS MEETING**

**11:45 a.m. - 12:45 p.m.**

**Deans Hall**

All attendees are welcome to join PELICAN Insurance, RRG for lunch and PELICAN member update.

### **BREAKOUT SESSION - "QUALITY MEASURES ARE MY FRIENDS"**

**1 - 2:30 p.m.**

**Room 206**

NHA – 1.5

RC/AL – 1.5

PC - 1.5

RN – 1.5

CPE - 1.5

CBDM - 1.5

Are you interested in improving your quality measures (QM) on your Five-Star Rating? Do you believe you need to be an active participant in knowing your Minimum Data Set (MDS) common coding errors that affect your quality measures? Who in your facility is responsible for, has the time, and has the knowledge to see the big picture of coding the MDS, completing insurance updates, CAA and person-centered care plans, and also knows how it all affects your quality measures? As a nursing home administrator, director of nursing or assistant director of nursing, you will learn why your focus needs to be on your QMs and how to prevent your Five-Star Rating from dropping. You will learn the QMs and how the data entered on the MDS affects each one, common coding errors that affect the QMs (although one mistake is not so easy to fix), and how the NAC can correct these errors. You will learn how therapy uses the QMs to aid in long-term care advocacy programming.

*Dave Lishinsky, PT, VP of Clinical Compliance*

*Kathy Kemmerer, LPNAC, RAC-CT 3.0, CPRA, CMI Specialist and Medicare Reimbursement Specialist*

*AdvantageCare Rehabilitation, LLC*

*Care Coordination Management, LLC*

*Advantage Home Health Services, LLC*

## **BREAKOUT SESSION - "CONTROLLING LEGIONELLA IN BUILDING WATER SYSTEMS"**

1 - 2:30 p.m.

Room 207

NHA – 1.5

RC/AL – 1.5

PC - 1.5

RN – 1.5

CBDM - 1.5

With ASHRAE 188 and CMS following this ASHRAE guideline, there is now a need to control Legionella in your building water systems. We will discuss the basic areas of risk in your building water systems and identify how a Water Safety Plan (WSP) is developed and what needs to be incorporated. This is a requirement for facilities to manage and maintain.

With your WSP, we will guide you step-by-step on how to manage and maintain your building water systems where they are controlling Legionella and other waterborne pathogens. Monitoring and remediation will be discussed along with the proper records management.

Today, without this water management plan in effect, you and your patients will be at risk. This common sense approach will allow you to put in place a program which will comply with the current guidelines and directives.

*Jeffrey L. Rudolph, Sr., CWT, President*

*Robert Maxson, CWT, LEED GA, Sales Representative*

*Klenzoid, Inc.*

## **AFTERNOON BREAK - SPONSORED BY 360CARE**

2:30 p.m.

Second Floor Break Area

## **BREAKOUT SESSION - "DISPENSING SOME CLARITY THROUGH THE HAZE: AN UPDATE ON MEDICAL MARIJUANA IN PA LONG-TERM CARE"**

2:45 - 3:45 p.m.

Room 206

NHA – 1

RC/AL – 1

PC - 1

RN – 1

CBDM - 1

Marijuana use - both medical and recreational - has been a topic of great debate in recent months. Some form of marijuana use is now legal in 29 states, and the District of Columbia. However, marijuana use and possession (even for medical purposes) are still a violation of Federal Law, and Attorney General Sessions is not a supporter. We'll discuss the state of the law in Pennsylvania, various forms of permissible use and health conditions that allow it, reasons residents and/or their physicians may have an interest in the use of marijuana, and the potential implications of allowing possession and use in a facility.

*Michael A. Hynum, Esq., Founder & Owner*

*Hynum Law*

## **BREAKOUT SESSION - "MANAGED CARE REIMBURSEMENT: A FULL CONTRACT SPORT"**

2:45 – 3:45 p.m.

Room 207

NHA – 1

RC/AL – 1

PC - 1

RN – 1

CPE - 1

CBDM - 1

To quote the great Wayne Gretzky, "A good hockey player plays where the puck is. A great hockey player plays where the puck is going to be."

With over 10 years of working with Managed Care Organizations (MCOs) across 15 states, we have learned how to prepare and anticipate the MCO's next move. By knowing this, we can show you how to avoid their typical - and sometimes not so typical - techniques that stand in the way of your reimbursement.

*Steve Shain, Chief Operating Officer  
LTC Contracting, LLC*

### **PACAH 2018 SPRING VENDOR SHOW - SPONSORED BY GUARDIAN ELDER CARE**

**3:45 - 6 p.m.**

**Presidents Hall**

Light hors d'oeuvres and a bar will keep the conversation flowing! Be sure to visit all of our vendors and receive signatures from each vendor on your booth layout map for a chance to win some great prizes!

### **CONFERENCE PARTY - SPONSORED BY APEX REHAB SOLUTIONS**

**8:30 – 11:30 p.m.**

**Senate Suite**

Time to break out the Hawaiian shirts for PACAH's and Apex Rehab Solutions' salute to all that is summer...PACAH's Beach Party! Let's warm up with hors d'oeuvres, beverages, and a D.J. to get everyone into a "summer" frame of mind!

## **FRIDAY, APRIL 27, 2018**

### **REGISTRATION**

**7 – 11:30 a.m.**

**Registration Desk One**

### **CONTINENTAL BREAKFAST**

**7 – 8 a.m.**

**Prefunction Presidents Hall 1**

### **GENERAL SESSION - "A PANEL DISCUSSION WITH THE MCOS"**

**8 - 9 a.m.**

**Presidents Hall 1**

NHA – 1

RC/AL – 1

PC – 1

RN – 1

CPE - 1

CBDM – 1

Community HealthChoices (CHC), Pennsylvania's Managed Long-term Supports and Services Program, was implemented in the Southwest on January 1, 2018. It is also set to be implemented in the Southeast on January 1, 2019. Hear from the three Managed Care Organizations (MCOs) on how implementation has gone, frequently asked questions, and other must know information for all providers. With implementation for all nursing facilities happening January 1, 2020, it is critical that all long-term care providers become prepared for the transition and hear critical updates and program information directly from the MCOs.

*Kelly Andrisano, J.D., Executive Director  
PACAH*

*Jill Blessington, Manager Provider, Network Management  
AmeriHealth Caritas Pennsylvania*



*Anna Keith, Senior Director, Strategic Partnerships  
PA Health & Wellness*

*Danielle Wachter, Network Manager  
UPMC Community HealthChoices*

## **BREAKOUT SESSION - "THE DATA IMPACT TO UPCOMING TRENDS IN SNF REIMBURSEMENT METHODOLOGIES"**

9 - 10 a.m.

Room 206

NHA – 1

RC/AL – 1

PC – 1

RN – 1

CPE - 1

CBDM – 1

We will discuss new, as well as proposed skilled nursing facility (SNF) reimbursement methodologies including bundled payments, SNF Quality Reporting Program (QRP), Value Based Purchasing (VBP) and the Resident Classification System (RCS-1) model. We will discuss the background behind these initiatives, the current implementation/timing status, and the impact to providers' reimbursement.

We will explain how these reimbursement models can impact providers and how trends will continue toward data collection and reporting to include in reimbursement models for post-acute providers. As we discuss these reimbursement models, we will share important state and national benchmarking data which providers can utilize to compare to their operations and results. We will direct attendees to the location of available data for their use. We will also discuss strategies for providers to consider to be successful in the new reimbursement environment.

We will also discuss the continuing trend toward Managed Care Organizations (MCOs) and their increasing role in state programs and provide perspectives on provider experiences in other states who have moved toward MCO's to manage their Medicaid programs.

*Denise A. Gadowski, CPA, Partner, Healthcare – Senior Care Focus  
Plante & Moran, PLLC*

## **BREAKOUT SESSION - "THREATS AND OPPORTUNITIES: EMPLOYMENT AND LABOR LAW BRIEFING 2018"**

9 - 10 a.m.

Room 207

NHA – 1

RC/AL – 1

PC – 1

RN – 1

CBDM – 1

Managers and human resources professionals must continue to stay up-to-date with the continued changes and developments in employment and labor laws. This presentation will examine some of the recent changes and developments in the law, and the threats and opportunities those changes present to employers.

*Michael McAuliffe Miller, Member  
Kevin M. Skjoldal, Member  
Eckert Seamans Cherin & Mellott, LLC*

## **MORNING BREAK**

10 a.m.

Second Floor Break Area

## **BREAKOUT SESSION - "MEDICAID ELIGIBILITY AND COLLECTIONS: RECOGNIZING PROBLEMS AND FINDING SOLUTIONS"**

10:15 - 11:15 a.m.

Room 206

NHA - 1

RC/AL - 1

PC - 1

RN - 1

CPE - 1

CBDM - 1

If you are new to the wonderful world of Medicaid reimbursement and collections, or a savvy veteran in search of a refresher course, this session will be beneficial. The presentation will focus on the Admission Agreement, the Medicaid application and appeal process, and the basic legal options available to obtain payment for services provided (including administrative appeals, civil litigation, guardianships, and potential criminal charges). The presentation is designed to give the audience the building blocks necessary to recognize a problem, identify the options, and choose the best course of action to follow given the circumstances.

*John Kennedy, Esq., President & CEO*

*Benjamin Glatfelter, Esq., Associate*

*Casey Slotter, Esq., Associate*

*Kennedy, PC Law Offices*

## **BREAKOUT SESSION - "DEALING WITH DIFFICULT FAMILIES"**

10:15 - 11:15 a.m.

Room 207

NHA - 1

RC/AL - 1

PC - 1

RN - 1

CBDM - 1

In long-term care, it is well-known that staff are not just working with their residents but also residents' families. This presentation will cover approaches that should be taken when working with multiple groups of people (residents and family members), especially ones who may have differing or conflicting opinions either between themselves and/or staff.

In this session, we will discuss:

- The influences on family satisfaction and why having family satisfaction is important.
- The power of empathy. Why do we need to show empathy for family and how far can it go when resolving an issue? The power of communication and the need to keep that on-going.
- The importance of discussing illness trajectories with families and remember that not all families have a medical background to understand what medical conditions their loved ones are facing.
- Team work and communication. Staff should be able to lean on each other for one another's expertise. They also need to stay consistent in their responses to families, especially difficult ones.

*Ronnie Edwards, MSW, LSW, Aging and Disability Coordinator*

*Aging Institute of UPMC Senior Services and University of Pittsburgh*

## **GENERAL SESSION - "DEPARTMENT OF HEALTH UPDATE"**

11:30 a.m. - 12:30 p.m.

Presidents Hall 1

NHA - 1

RC/AL - 1

PC - 1

RN - 1

CPE - 1

CBDM - 1

Pennsylvania nursing facilities are currently seeing a renewed focus on surveys and fines. We are also operating under new Requirements of Participation and a new survey process that began November 2017. That combined

with continued Life Safety Code (LSC) and Fire Safety Code (FSC) updates and issues, its imperative that members remain up-to-date with information from Pennsylvania's Department of Health (DOH). This session will feature the director of the division of nursing care facilities who will provide timely information on the operations of her department as it relates to surveys and licensing. She will discuss updates and statistical data on Pennsylvania's nearly 700 nursing facilities, new emphasis from the federal government, and other issues impacting nursing facilities from the perspective of licensing and surveys. The director of the division of safety inspection will also provide updates on critical LSC issues.

*Charles Schlegel, Director, Division of Safety Inspection*  
*Susan Williamson, Director, Division of Nursing Care Facilities*  
*Pennsylvania Department of Health, Division of Long-Term Care*



**SAVE THE DATE**

**PACAH**

Pennsylvania Coalition of Affiliated  
Healthcare & Living Communities

# 2018 FALL CONFERENCE

September 24 - 27

Pocono Mountains, PA





# PACAH 2018 SPRING CONFERENCE SPEAKERS

**Kelly Andrisano, J.D.**  
**Executive Director**  
PACAH  
PO Box 60769  
Harrisburg, PA 17106-0769  
(717) 736-4740

**Jill Blessington**  
**Manager Provider, Network Management**  
AmeriHealth Caritas Pennsylvania  
8040 Carlson Rd, Ste 500  
Harrisburg, PA 17112  
(717) 651-3540

**Tanya Daniels-Harris, Esq.**  
**Senior Attorney**  
Latsha, Davis & McKenna, P.C.  
1700 Bent Creek Blvd, Ste 140  
Mechanicsburg, PA 17050  
(717) 620-2424

**John P. DiMaggio**  
**Co-Founder & CEO**  
BlueOrange Compliance  
5131 Post Rd, Ste 240  
Dublin, OH 43017  
(855) 500-6272

**Ronnie Edwards, MSW, LSW**  
**Aging and Disability Coordinator**  
Aging Institute of UPMC Senior Services and University of Pittsburgh  
Forbes Tower, 3600 Forbes Ave at Meyran, Ste 10072  
Pittsburgh, PA 15213  
(412) 647-1897

**Edward P. Frigo**  
**Director, Fiscal Services**  
Premier Healthcare Resources  
2030 Ader Rd  
Penn Township, PA 15644  
(724) 327-0063

**Denise A. Gadomski, CPA**  
**Partner, Healthcare - Senior Care Focus**  
Plante & Moran, PLLC  
111 Superior Ave, Ste 1250  
Cleveland, OH 44114  
(216) 274-6514

**Benjamin Glatfelter, Esq.**  
**Associate**  
Kennedy, PC Law Offices  
PO Box 5100  
Harrisburg, PA 17110  
(717) 233-7100

**Lisa Gourley, RN, RAC-CT 3.0**  
**Clinical Reimbursement Specialist**  
Complete Healthcare Resources - Eastern, Inc.  
200 Dryden, Rd, Ste 3100  
Dresher, PA 19025  
(800) 951-0410

**Tracey Graham, RN, MSN, MSM, CEN NP-C, DNP**  
**Senior Healthcare Strategist**  
Stantec Architecture  
650 Smithfield St, Ste 2500  
Pittsburgh, PA 15222  
(412) 394-7000

**Ginny Grant, PT**  
**Area Director**  
Premier Therapy, LLC  
110 Central Square Dr  
Beaver Falls, PA 15010  
(724) 775-8669

**Thomas S. Grden, AIA**  
**Principal**  
Stantec Architecture  
650 Smithfield St, Ste 2500  
Pittsburgh, PA 15222  
(412) 394-7000

**Cynthia A. Haines, Esq.**  
**Principal**  
Post & Schell, P.C.  
17 N. 2nd St, 12th Fl  
Harrisburg, PA 17110  
(717) 612-6027

**Michael A. Hynum, Esq.**  
**Founder & Owner**  
Hynum Law  
2608 N Third St  
Harrisburg, PA 17110  
(717) 774-1357

**Anna Keith**  
**Senior Director, Strategic Partnerships**  
PA Health & Wellness  
300 Corporate Center Dr  
Camp Hill, PA 17011  
(717) 551-8094

**Kathy Kemmerer, LPNAC, RAC-CT 3.0**  
**CPRA**  
**CMI Specialist/Medicare Reimbursement Specialist**  
AdvantageCare Rehabilitation, LLC  
Care Coordination Management, LLC  
Advantage Home Health Services, LLC  
5035 Clairton Blvd  
Pittsburgh, PA 15236  
(412) 440-0145

**John Kennedy, Esq.**  
**President & CEO**  
Kennedy, PC Law Offices  
PO Box 5100  
Harrisburg, PA 17110  
(717) 233-7100

**Michael J. Kessler, III, CPA, CGMA**  
**Senior Manager - Health Care Services**  
Arnett Carbis Toothman, LLP  
2599 Wilmington Rd  
New Castle, PA 16105  
(724) 658-1565

**Edward J. Klik, Jr.**  
**Partner - Health Care Services, Director of Reimbursement Services**  
Arnett Carbis Toothman, LLP  
2599 Wilmington Rd  
New Castle, PA 16105  
(724) 658-1565

**David Lishinsky, PT**  
**VP of Clinical Compliance**  
AdvantageCare Rehabilitation, LLC  
Care Coordination Management, LLC  
Advantage Home Health Services, LLC  
5035 Clairton Blvd  
Pittsburgh, PA 15236  
(412) 440-0145

**Robert Maxson, CWT, LEED GA**  
**Sales Representative**  
Klenzoid Inc.  
912 Spring Mill Ave  
Conshohocken, PA 19428  
(610) 825-9494

# PACAH 2018 SPRING CONFERENCE SPEAKERS

**Michael McAuliffe Miller, Esq.  
Member**

Eckert Seamans Cherin & Mellott, LLC  
213 Market St, 8th Fl  
Harrisburg, PA 17101  
(717) 237-6000

**Heather Meadows, CCC/SLP/CDP  
Executive Director of PA**

Premier Therapy, LLC  
110 Central Square Dr  
Beaver Falls, PA 15010  
(724) 775-8669

**Peggy Morningstar, Esq., CPA, CFE  
Chief Financial Officer**

Department of Human Services  
Office of Long-Term Living  
625 Forster St  
Harrisburg, PA 17120  
(717) 787-1870

**Judith Patrick**

**Policy Manager, Bureau of Policy and  
Regulatory Management**

Department of Human Services  
Office of Long-Term Living  
625 Forster St  
Harrisburg, PA 17120  
(717) 787-1870

**Jake Poore**

**President & Chief Experience Officer**

Integrated Loyalty Systems  
13538 Village Park Dr, Ste 120  
Orlando, FL 32837  
(407) 859-2826

**Mark R. Ross, CHEP**

**Regional Manager, Emergency  
Preparedness**

Hospital & Healthsystem Association of  
Pennsylvania  
30 N. 3rd St, Ste 600  
Harrisburg, PA 17101  
(717) 564-9200

**Jeffrey Rudolph, Sr., CWT  
President**

Klenzoid Inc.  
912 Spring Mill Ave  
Conshohocken, PA 19428

**Rebecca Rumsky, COTA/L  
Program Director**

Premier Therapy, LLC  
110 Central Square Dr  
Beaver Falls, PA 15010  
(724) 775-8669

**Paula Sanders, Esq.**

**Principal & Chair, Healthcare Practice**

Post & Schell, P.C.  
17 N. 2nd St, 12th Fl  
Harrisburg, PA 17110  
(717) 612-6027

**Kara Schilling RN, RAC-CT 3.0**

**Clinical Reimbursement Specialist**

Complete Healthcare Resources -  
Eastern, Inc.  
200 Dryden, Rd, Ste 3100  
Dresher, PA 19025  
(800) 951-0410

**Charles Schlegel**

**Director, Division of Safety Inspection**

Pennsylvania Department of Health  
2150 Herr St, 1st Fl  
Harrisburg, PA 17103  
(717) 787-1911

**Steve Shain**

**Chief Operating Officer**

LTC Contracting, LLC  
100 Blvd of the Americas  
Lakewood, NJ, 08701  
(732) 276-7624

**Kevin Skjoldal, Esq.**

**Member**

Eckert Seamans Cherin & Mellott, LLC  
213 Market St, 8th Fl  
Harrisburg, PA 17101  
(717) 237-6000

**Casey Slotter, Esq.  
Associate**

Kennedy, PC Law Offices  
PO Box 5100  
Harrisburg, PA 17110  
(717) 233-7100

**Margaret Turner, RN, RAC-CT  
Senior Director, Clinical  
Reimbursement**

Complete Healthcare Resources -  
Eastern, Inc.  
200 Dryden, Rd, Ste 3100  
Dresher, PA 19025  
(800) 951-0410

**Danielle Wachter**

**Network Manager**

UPMC Community HealthChoices  
U.S. Steel Tower, 10th Fl  
600 Grant St  
Pittsburgh, PA 15219  
(412) 454-5289

**Renz A. Weinmann, A.I.A, LEED AP  
BD&C**

**Associate Architect**

Stantec Architecture  
650 Smithfield St, Ste 2500  
Pittsburgh, PA 15222  
(412) 394-7000

**Susan Williamson**

**Director, Division of Nursing Care  
Facilities**

Pennsylvania Department of Health  
625 Forster St  
Harrisburg, PA 17120  
(717) 787-1870

**John Whitman, MBA, NFA**

**Founder & Executive Director**

The TRECS Institute  
105 Thatcher Ct  
North Wales, PA 19454  
(484) 557-6980

We thank PACAH's 2018 Spring Conference speakers for their time and knowledge.  
Your contribution helps to ensure a successful conference, year after year!

# NEW TO PACAH

PERSONAL CARE & ASSISTED LIVING MEMBERSHIP

**PACAH is excited to announce a new membership opportunity for personal care or assisted living entities - just \$100 annually!**

Assisted living and personal care entities are encouraged to join PACAH's new educational membership class. This membership is available **ONLY to assisted living and personal care administrators**, and entitles the administrator and staff of each member facility to participate in educational opportunities offered by PACAH at membership prices, as well as receive additional benefits including participation in the listserv, email blasts with pertinent information, receipt of newsletters and much more!

PACAH now also offers continuing education credits for assisted living and personal care administrators at our conferences **AND** will be offering additional educational opportunities focused on issues specific to personal care and assisted living entities.



**THE LANDSCAPE OF LONG-TERM CARE IS CHANGING - DON'T MISS OUT!**

*Enjoy the educational benefits of an established state-wide association at a low price!*

## CONTACT

Kelly Andrisano  
[kandrisano@pacounties.org](mailto:kandrisano@pacounties.org)  
(717) 736-4740

Kim Deline  
[kdeline@pacounties.org](mailto:kdeline@pacounties.org)  
(717) 736-4741

# PACAH

Pennsylvania Coalition of Affiliated  
Healthcare & Living Communities





A Sponsored Program of PACAH

PELICAN is a Reciprocal Risk Retention Group, which provides Professional Liability and General Liability Insurance coverage.

## WHY PELICAN?

- PELICAN offers dedicated and personal Risk Control and Claims Representatives who are focused on providing excellent customer services to PELICAN members.
- PELICAN has risk management services that provide members with the expertise of a qualified risk control specialist. The specialist may identify potential hazards or loss causing conditions and make recommendations to help the member control these exposures.
- PELICAN offers a risk control credit program that rewards subscribers who participate in risk control activities with a reduction of their premium costs, up to 5 percent annually!
- Since 2010, \$6 million has been returned to the members in dividends!
- PELICAN bed rate is \$380!

**Contact Andrew Smith at [asmith@pacounties.org](mailto:asmith@pacounties.org) to hear more about all that PELICAN has to offer!**

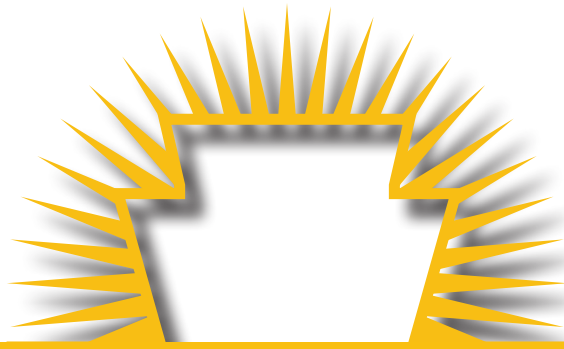

# PACAH

Pennsylvania Coalition of Affiliated  
Healthcare & Living Communities

PO Box 60769  
Harrisburg, PA 17106-0769  
(717) 526-1010  
fax (717) 526-1020

[www.pacahpa.org](http://www.pacahpa.org)



[www.facebook.com/pacahpa](http://www.facebook.com/pacahpa)



[www.linkedin.com/company/pacah](http://www.linkedin.com/company/pacah)



[www.twitter.com/PACAHPa](http://www.twitter.com/PACAHPa)